

# WAREHOUSE DEVELOPMENT

# NO.39 CERES DRIVE

# THURGOONA, NSW 2640

## CIVIL WORKS

CIVIL GENERAL NOTES

- THESE DRAWINGS SHALL BE READ IN CONJUNCTION WITH ALL ARCHITECTURAL & OTHER CONSULTANTS' DRAWINGS & SPECIFICATIONS & SUCH OTHER WRITTEN INSTRUCTIONS AS MAY BE ISSUED DURING THE COURSE OF THE CONTRACT. ANY DISCREPANCY SHALL BE REFERRED TO THE ENGINEER BEFORE PROCEEDING WITH THE WORK.
- MATERIALS & WORKMANSHIP SHALL BE IN ACCORDANCE WITH THE RELEVANT AUSTRALIAN STANDARDS.
- BUILDER TO CONFIRM THE LOCATION OF ALL EXISTING SERVICES PRIOR TO COMMENCING ANY WORK ON SITE AND ALLOW FOR RELOCATION IF REQUIRED, INCLUDING INVERT LEVELS AT THE LEGAL POINT OF DISCHARGE. SERVICE INFORMATION SHOWN IS BASED ON PLANS SUPPLIED BY AUTHORITIES & IS APPROXIMATE ONLY. THE BUILDER IS TO COMPLY WITH ALL OF THE REQUIREMENTS OF THOSE SERVICES AUTHORITIES.
- THE CONTRACTOR SHALL COMPLY WITH ALL REGULATIONS OF AUTHORITIES HAVING JURISDICTION OVER THE WORKS.
- PRIOR TO THE COMMENCEMENT OF ANY WORKS THE CONTRACTOR MUST VERIFY THAT THE DRAWINGS HAVE BEEN APPROVED BY THE RELEVANT AUTHORITIES.
- THESE DRAWINGS MUST NOT BE SCALED AND FOR SITE SET OUT DIMENSIONS REFER TO ARCHITECTS DRAWINGS.
- ALL DIMENSIONS & REDUCED LEVELS MUST BE VERIFIED ON SITE BEFORE THE COMMENCEMENT OF ANY WORK.
- ANY PROPRIETARY PRODUCTS THAT ARE SPECIFIED ON THESE DRAWINGS (OR APPROVED BY THIS OFFICE) ARE TO BE INSTALLED IN ACCORDANCE WITH THE MANUFACTURES DETAILS AND SPECIFICATIONS.
- SUBSTITUTIONS MUST BE APPROVED BY THE ENGINEER.
- ANY DEFECT OR DEVIATION FROM THE CONTRACT DOCUMENTS THAT REQUIRES ASSESSMENT AND DETERMINATION OF CORRECTIVE MEASURES BY THE ENGINEER SHALL BE UNDERTAKEN AT THE CONTRACTOR'S EXPENSE.
- A MINIMUM OF 48 HOURS NOTICE SHALL BE GIVEN FOR ALL WORKS REQUIRING ATTENDANCE ON SITE BY THE ENGINEER. CONTRACTOR TO ENSURE THAT SUBJECT WORKS ARE COMPLETE PRIOR TO INSPECTION.
- ALL LEVELS SHOWN ARE TO AUSTRALIAN HEIGHT DATUM BASED ON THE INFORMATION PROVIDED ARCHITECTURAL DRAWINGS. CONTRACTOR TO VERIFY LEVELS AND TBM PRIOR TO COMMENCEMENT OF WORKS.
- THE CONTRACTOR SHALL ARRANGE FOR THE WORKS TO BE SET OUT BY A LICENSED SURVEYOR.
- EXISTING SURFACE CONTOURS, WHERE SHOWN, ARE INTERPOLATED & MAY NOT BE ACCURATE.
- CONTRACTOR IS TO ARRANGE WITH THE RELEVANT STATUTORY AUTHORITIES FOR ALL NECESSARY INSPECTIONS AND APPROVALS. ALL WORK WITHIN ROAD RESERVES ETC. TO BE CARRIED OUT TO THE SATISFACTION OF THE RELEVANT AUTHORITIES.
- AS FAR AS REASONABLY PRACTICABLE, THE WORKS SHALL BE MAINTAINED IN A NOMINALLY DRY CONDITION WHILE THEY ARE IN PROGRESS, AND PARTICULAR CARE SHALL BE TAKEN TO PREVENT DUSTING, FLOODING, PONDING, SEEPAGE AND EROSION.
- ANY STRUCTURES, PAVEMENTS OR SURFACES DAMAGED, DIRTIED OR MADE UNSERVICEABLE DUE TO CONSTRUCTION WORK SHALL BE REINSTATED TO THE SATISFACTION OF THE ENGINEER, CLIENT AND THE RELEVANT AUTHORITY.
- THE CONTRACTOR TO PROVIDE AS BUILT DRAWINGS OF ALL THEIR WORKS IN BOTH DIGITAL AND HARDCOPIES FOR REVIEW.
- ALL NEW WORKS SHALL MAKE A SMOOTH JUNCTION WITH EXISTING.
- THE CONTRACTOR SHALL INSTALL AND MAINTAIN SOIL EROSION AND SEDIMENT CONTROL MEASURES GENERALLY IN ACCORDANCE WITH THE GUIDELINES OF THE E.P.A. AND AS NECESSARY TO PREVENT RUN-OFF FROM THE SITE OF SEDIMENT RESULTING FROM HIS WORKS. SUCH MEASURES SHALL ALSO COMPLY WITH REQUIREMENTS OF THE RELEVANT AUTHORITY.
- THESE DRAWINGS SHALL NOT BE USED FOR CONSTRUCTION UNTIL THE DRAWING REVISION IS NOTED AS "APPROVED FOR CONSTRUCTION".
- THE CONTRACTOR SHALL BE RESPONSIBLE FOR AND AT ALL TIMES PROVIDE A SAFE WORKING ENVIRONMENT IN THE VICINITY OF WORKS IN ACCORDANCE WITH ALL OCCUPATIONAL HEALTH AND SAFETY REGULATIONS.
- PRIOR TO COMMENCEMENT OF WORKS THE CONTRACTOR MUST VERIFY THE FEASIBILITY OF THE OUTFALL DRAINAGE TO THE LEGAL POINT OF DISCHARGE AS DOCUMENTED BY:
  - VERIFICATION OF THE INVERT LEVEL OF THE DRAIN COMPRISING THE LEGAL POINT OF DISCHARGE.
  - VERIFICATION THAT THE ROUTE OF THE DRAINAGE IS CLEAR OF ALL OBSTRUCTIONS AND EXISTING SERVICES.IF EITHER OF THE ABOVE CANNOT BE ACHIEVED THE CONTRACTOR IS TO NOTIFY LAKER GROUP PRIOR TO PROCEEDING WITH WORKS.
- ALL EARTHWORKS ARE TO BE PERFORMED IN ACCORDANCE WITH AS 3798. REFER TO THE RELEVANT GEOTECHNICAL REPORT PRIOR TO COMMENCEMENT OF WORKS.
- UNLESS OTHERWISE NOTED, ALL VEGETATION AND ORGANIC MATERIAL SHALL BE STRIPPED TO A MINIMUM OF 150mm OR AS SPECIFIED IN THE GEOTECHNICAL REPORT TO THE GREATER VALUE UNDER ALL PROPOSED PAVEMENTS AND BUILDING AREAS. STOCKPILE TOPSOIL IN DESIGNATED AREAS FOR REUSE IN LANDSCAPING WORKS OTHERWISE REMOVE OFFSITE.

EARTHWORKS

PRELIMINARY ISSUE

NOT TO BE USED FOR CONSTRUCTION PURPOSES

LAKER  
GROUP

| E | info@lakergroup.com.au | W | www.lakergroup.com.au

WAREHOUSE DEVELOPMENT  
39 CERES DRIVE  
THURGOONA, NSW 2640



WARNING  
BEWARE OF UNDERGROUND SERVICES

THE LOCATIONS OF UNDERGROUND SERVICES ARE APPROXIMATE ONLY AND THEIR EXACT SIZE, DEPTH AND LOCATION MUST BE PROVEN ON SITE. NO GUARANTEE IS GIVEN THAT ALL EXISTING SERVICES ARE SHOWN.

COVER SHEET,  
GENERAL NOTES AND  
DRAWING REGISTER

DRAWING INDEX

C01	COVER SHEET, GENERAL NOTES AND DRAWING REGISTER
C02	GROUND FLOOR DRAINAGE PLAN
C03	CIVIL DETAILS SHEET 1 OF 2
C03	CIVIL DETAILS SHEET 2 OF 2

Rev.	Revision Description	Date
P1	PRELIMINARY ISSUE	06.11.24

All civil drawings shall be read in conjunction with the Specification and Architectural drawings, and shall not be scaled.  
All discrepancies are to be referred to the Architect or Engineer before commencing work.  
All dimensions and levels are to be verified on site by the Builder before commencing work.

Scale: AS SHOWN AT A1

Designed: J.B. Drawn: J.B.

Date: NOV 2024

Project No. Drawing No. Revision

JB109 C01 P1







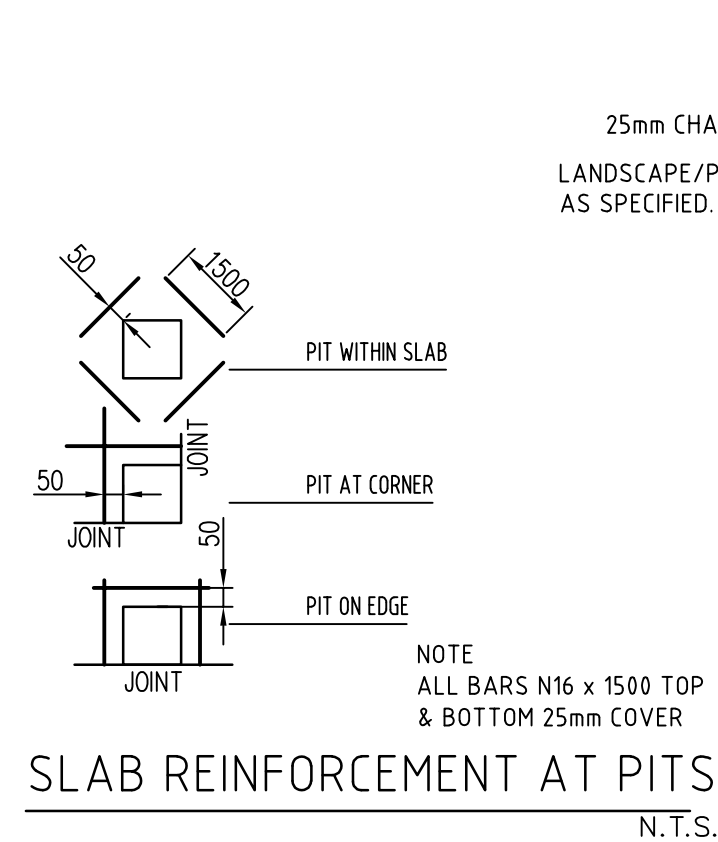

### TRENCH BACK FILLING DETAIL UNDER LANDSCAPED AREAS

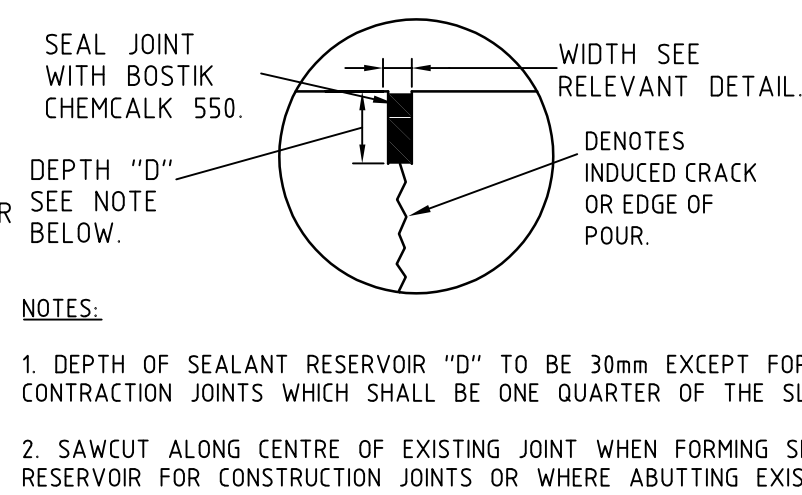

CONSTRUCTION JOINT (C.J.)

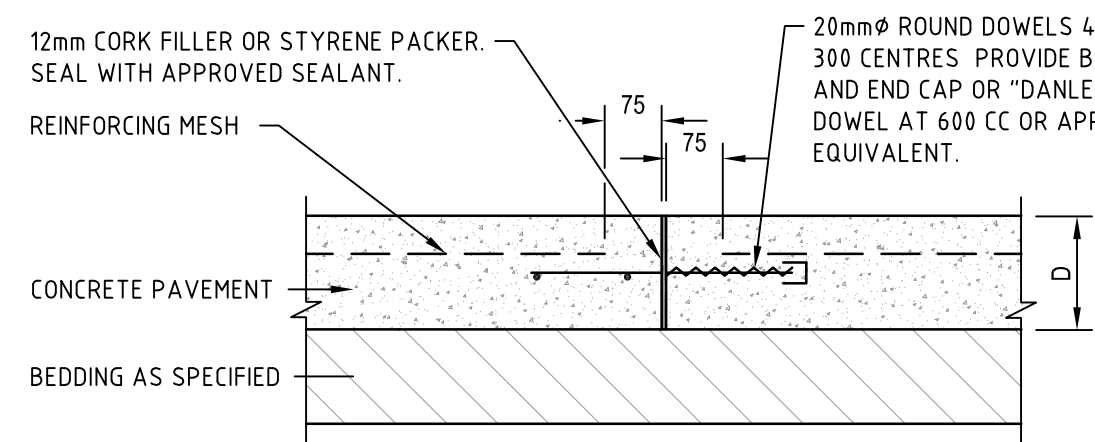

### DOWELLED EXPANSION JOINT (E.J.)

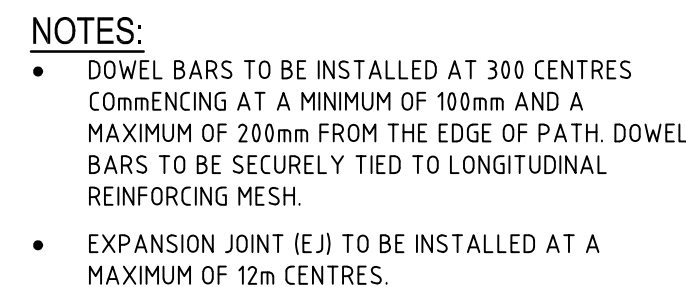

### TYPICAL KERB OPENING DETAIL

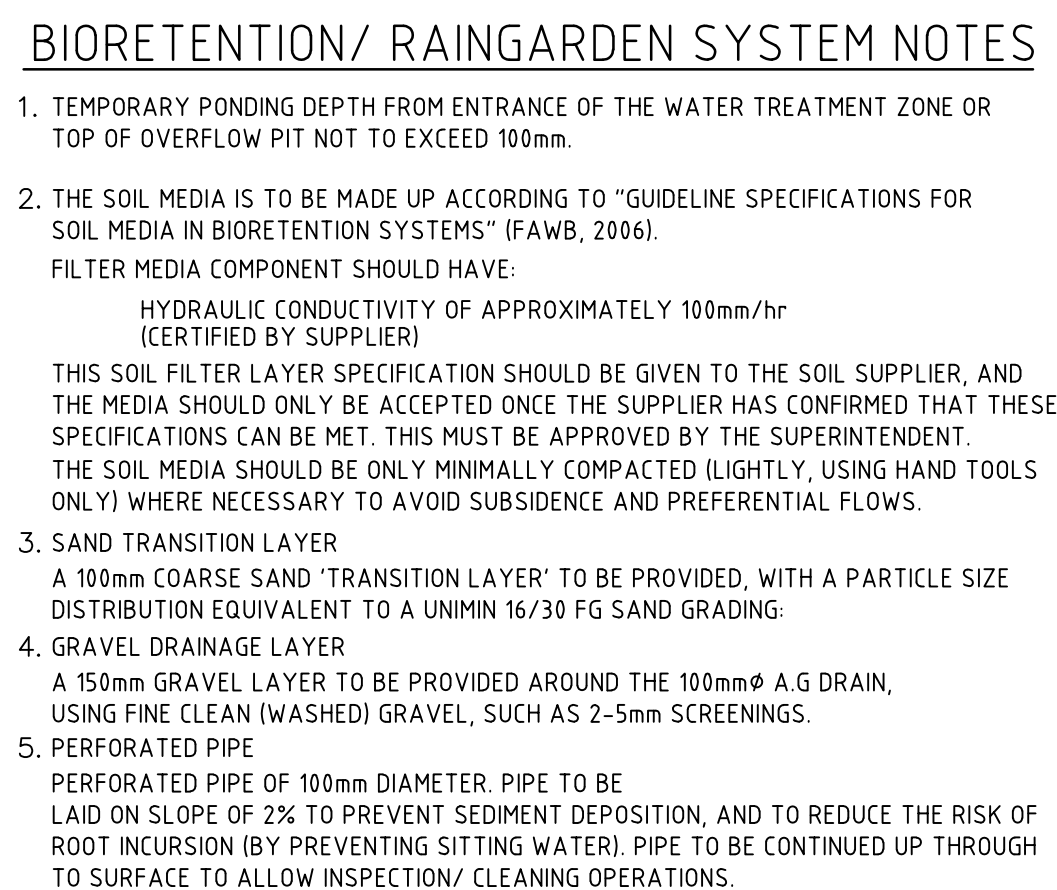

TYPICAL BIO-RETENTION/ RAINGARDEN CROSS SECTION

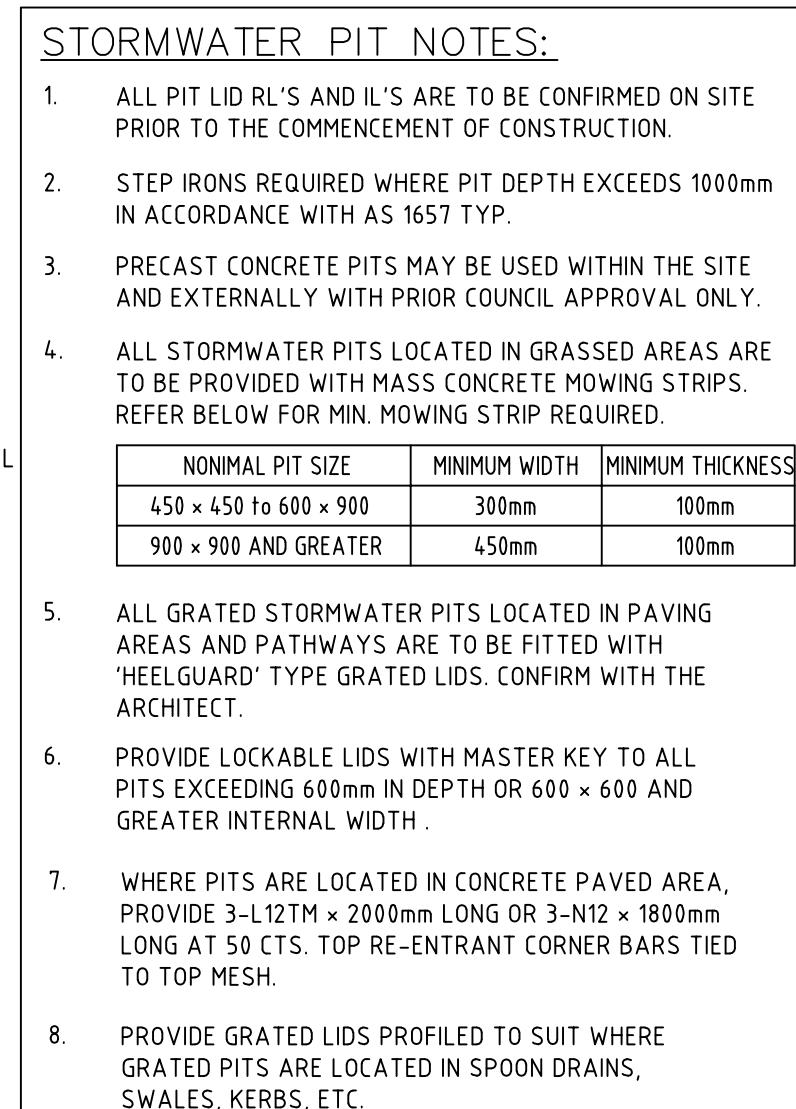

## TYPICAL PIT DETAILS

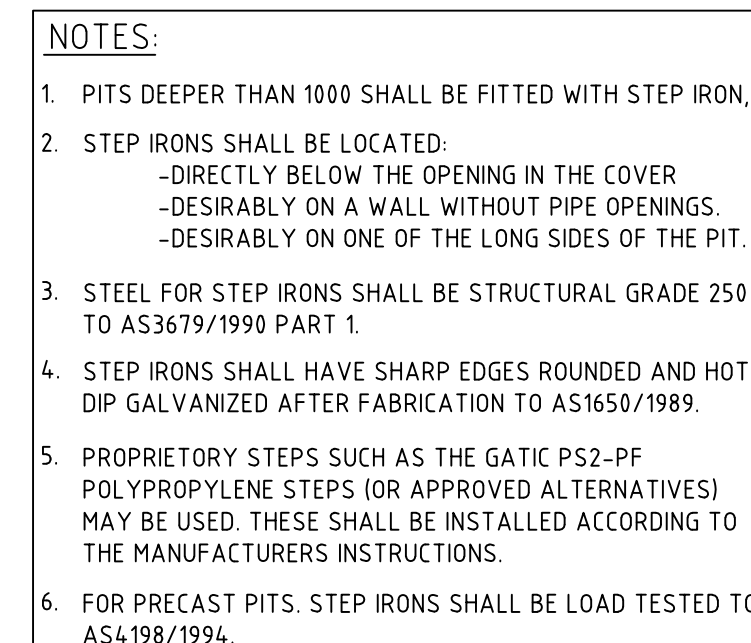

## TYPICAL STEP IRON DETAILS

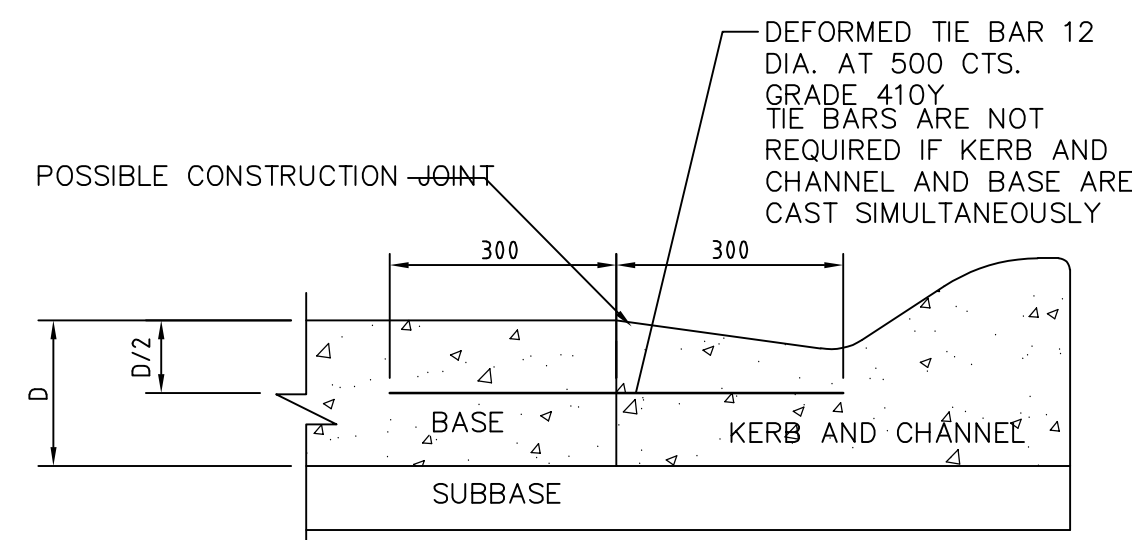

BARRIER KERB (B1) DETAIL

### CONCRETE KERB AND CHANNEL (B2) DETAIL

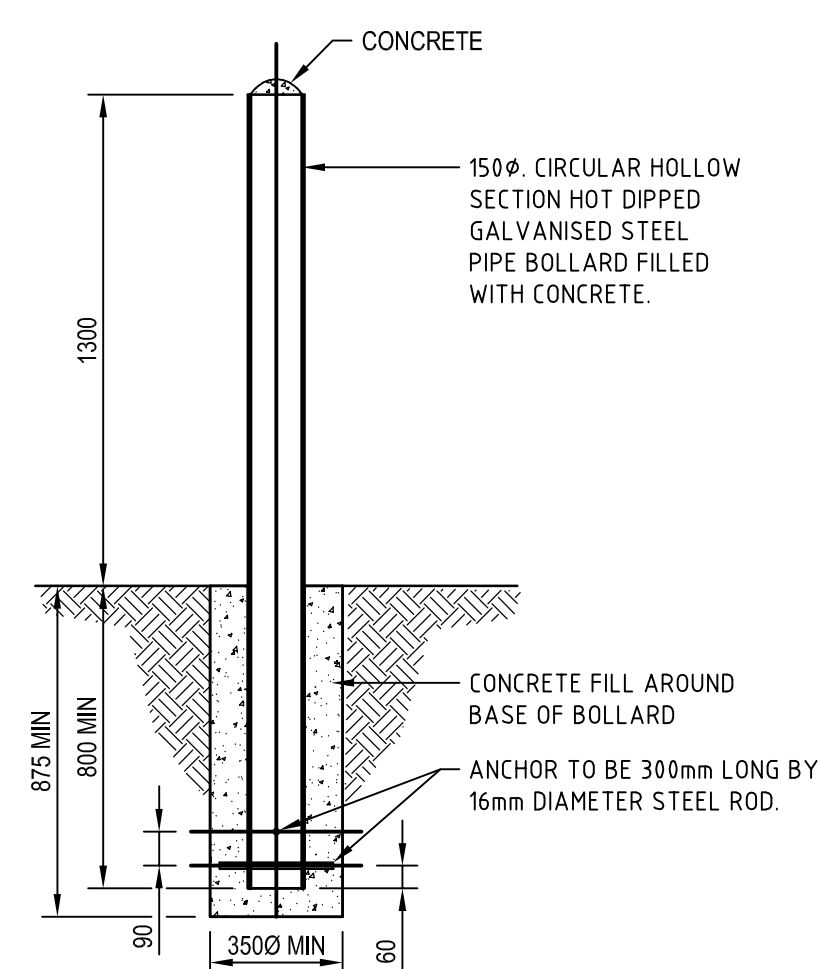

BOLLARD DETAIL

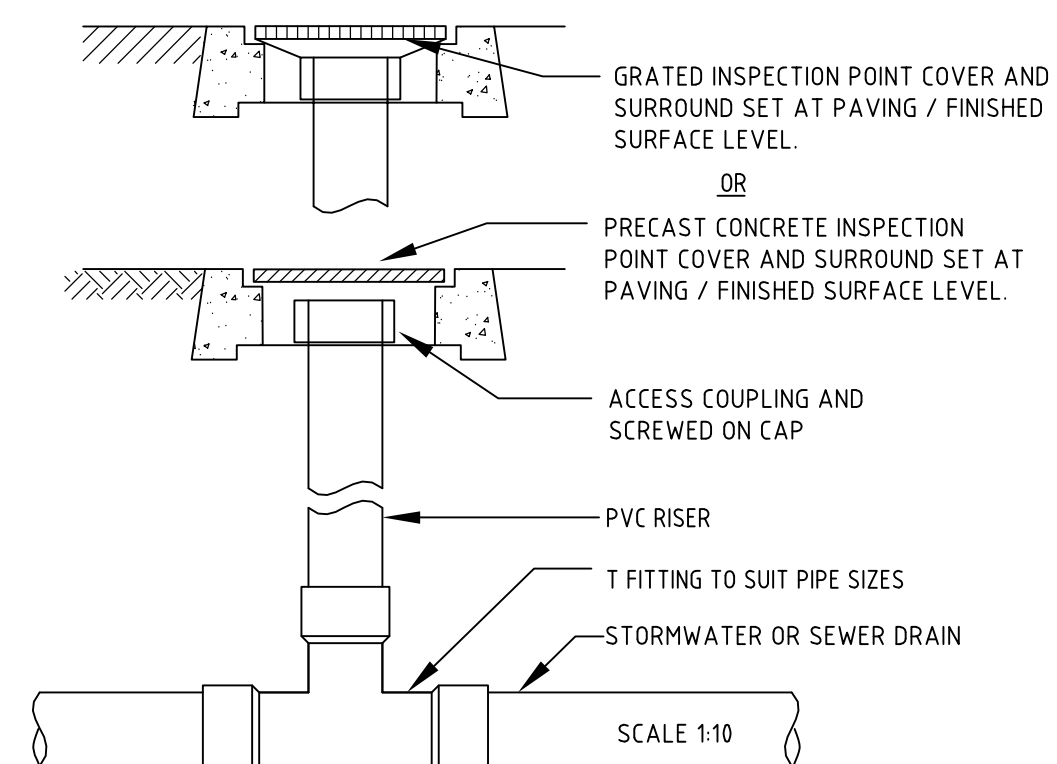

INSPECTION OPENING DETAIL

Rev.	Revision Description	Date
P1	PRELIMINARY ISSUE	06.11.24

- All Civil drawings shall be read in conjunction with the Specification and Architectural drawings, and shall not be scaled.
- All discrepancies are to be referred to the Architect or Engineer before commencing work.
- All dimensions and levels are to be verified on site by the Builder before commencing work.

**PRELIMINARY ISSUE**  
NOT TO BE USED FOR CONSTRUCTION PURPOSES

NOT TO BE USED FOR CONSTRUCTION PURPOSES

**LAKER**  
GROUP

| E | [info@lakergroup.com.au](mailto:info@lakergroup.com.au) | W | [www.lakergroup.com.au](http://www.lakergroup.com.au)

WAREHOUSE DEVELOPMENT  
39 CERES DRIVE  
THURGOONA, NSW 2640

CIVIL DETAILS  
SHEET 1 OF 2

Scale: AS SHOWN		AT A1
Designed: J.B.	Drawn: J.B.	
Date: NOV 2024		
Project No.	Drawing No.	Revision
JB109	C03	P1

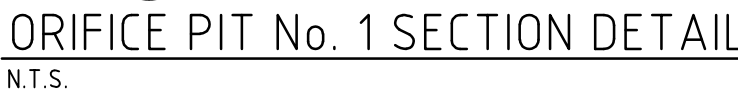

**PIT NOTES**

THE FOLLOWING APPLIES UNLESS NOTED OTHERWISE:

1. PIT COVER LEVELS ARE TO BE TAKEN FROM THE CENTRE OF THE PIT.
2. ALL PIT COVERS ARE TO SLOPE TO MATCH THE SURROUNDING FINISHED SURFACE LEVELS/SLOPES.
3. ALL PIT COVERS LARGER THAN 900X600 ARE TO BE MULTI PART COVERS.
4. ALL COVERS ARE TO MATCH THE PIT OPENING DIMENSIONS.
5. INSTALL STEP IRONS @ 300mm CENTRES FOR PITS 1.0M OR DEEPER.

- All Civil drawings shall be read in conjunction with the Specification and Architectural drawings, and shall not be scaled.
- All discrepancies are to be referred to the Architect or Engineer before commencing work.
- All dimensions and levels are to be verified on site by the Builder before commencing work.

NOT TO BE USED FOR CONSTRUCTION PURPOSES



WAREHOUSE DEVELOPMENT  
39 CERES DRIVE  
THURGOONA, NSW 2640

CIVIL DETAILS  
SHEET 2 OF 2

Scale: AS SHOWN		AT A1
Designed: J.B.	Drawn: J.B.	
Date: NOV 2024		
Project No.	Drawing No.	Revision
JB109	C04	P2