

Rev.	Date	Description
T1	03.08.2022	ISSUED FOR TENDER

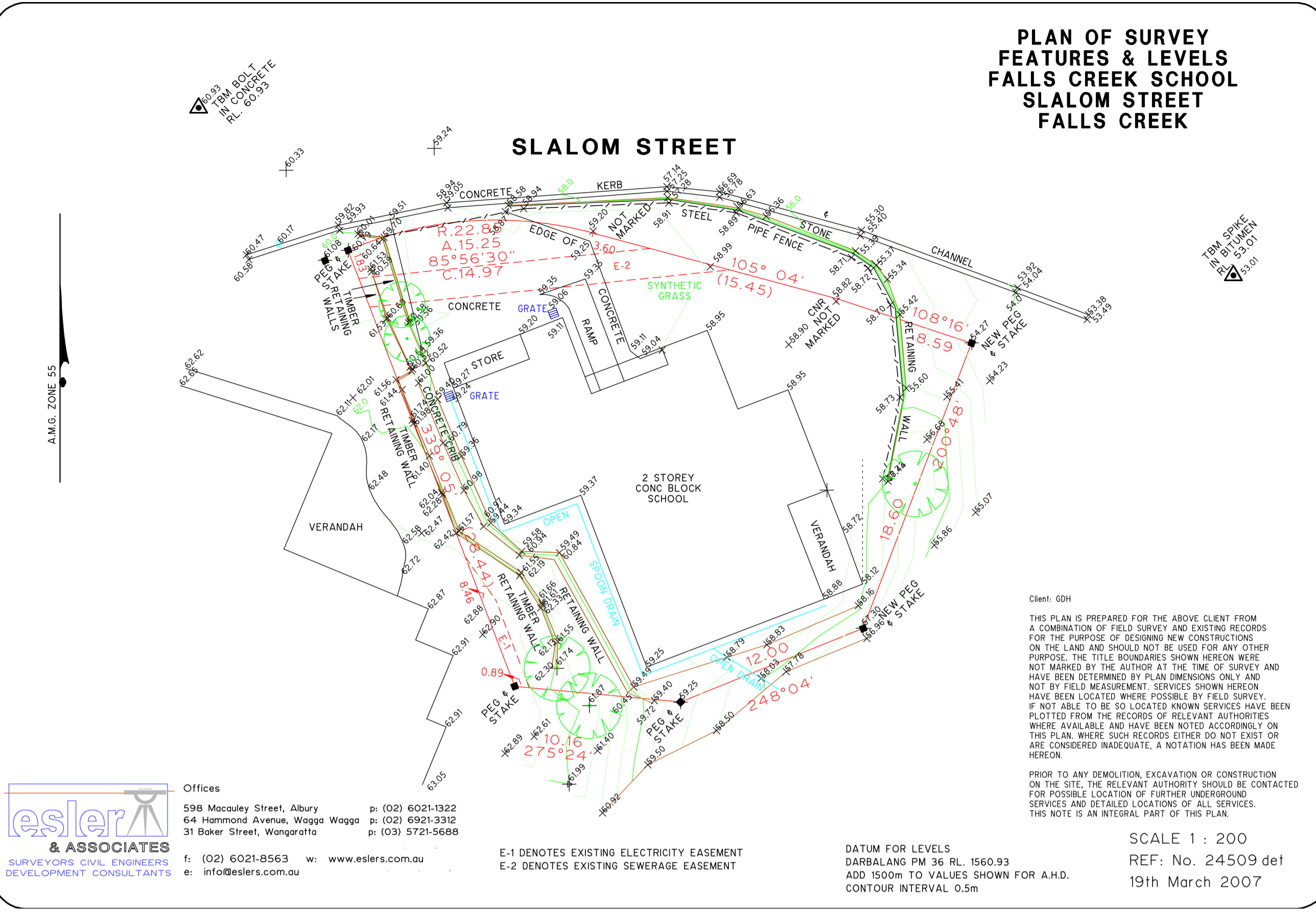

esler & ASSOCIATES
SURVEYORS CIVIL ENGINEERS
DEVELOPMENT CONSULTANTS

Offices
598 Macculey Street, Albury ph: (02) 6021-1322
64 Hammond Avenue, Wagga Wagga ph: (02) 6921-3342
31 Baker Street, Wangaratta ph: (03) 5721-5688

f: (02) 6021-8563 w: www.eslers.com.au
e: info@eslers.com.au

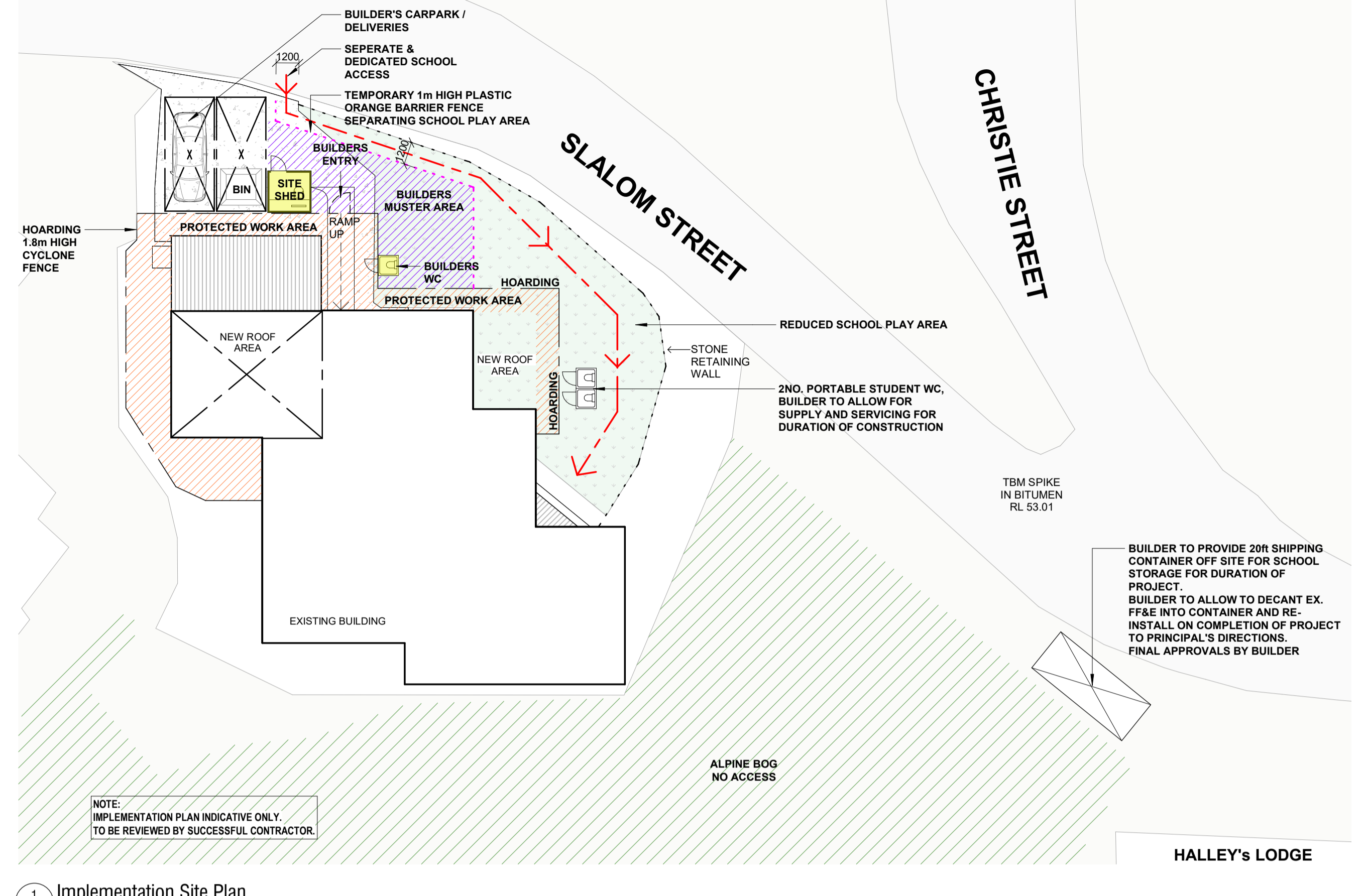

Existing Fire Hydrant Location

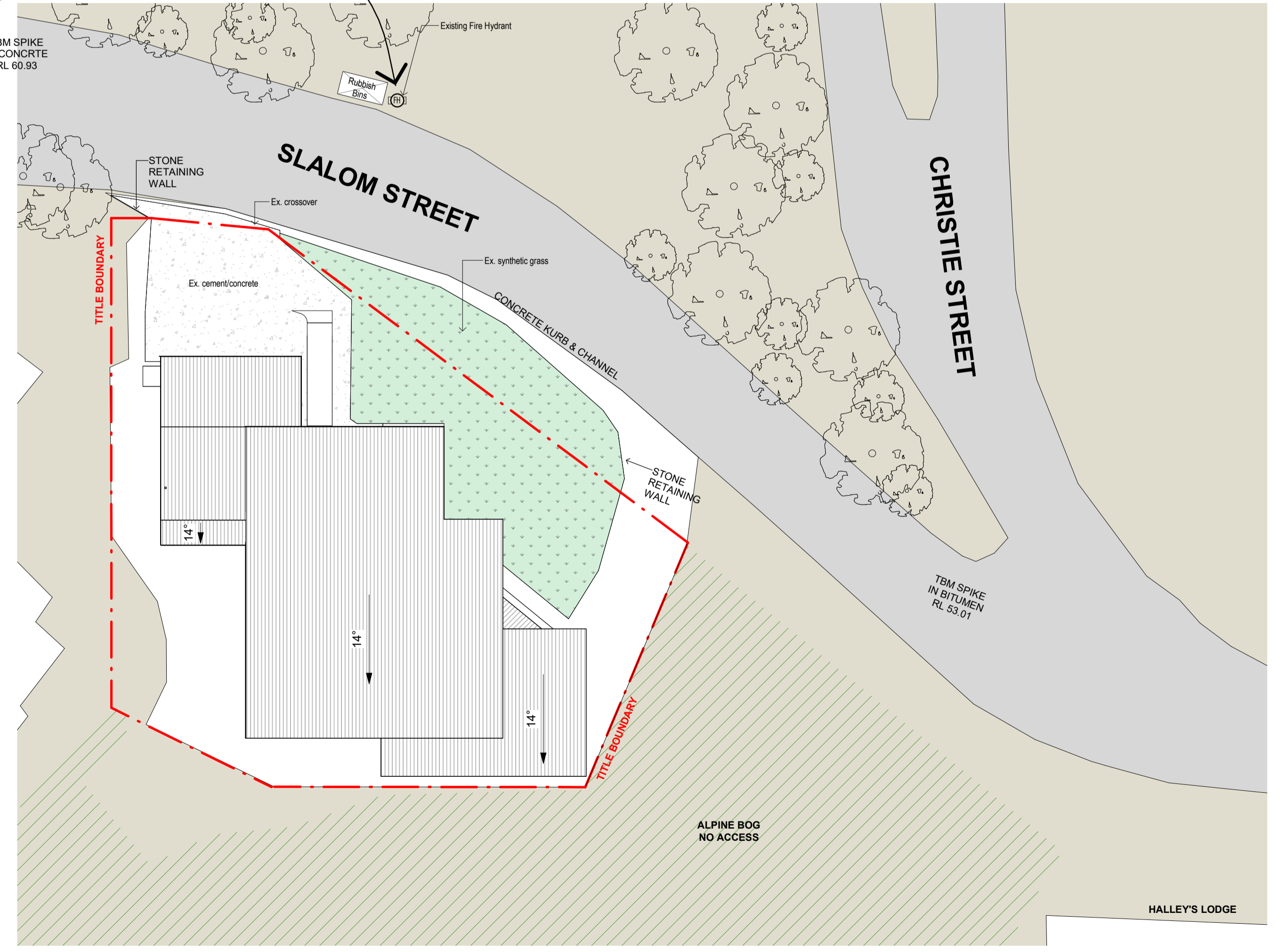

NOTE:

- Builder must allow to decant school equipment into 20ft storage container located off site on Slalom street. Expensive equipment must be properly protected with bubble wrap or similar for the duration of construction.
- Builder must allow to move all school equipment back into relevant locations (as guided by school principal) upon completion of building works and issue of Certificate of Occupancy Permit.

maddison architects
maddison architects Pty Ltd | 1st Floor 98 Bank St. South Melbourne VIC 3205 | 03 9666 3636
maddison@maddisonarchitects.com.au | abn: 91 007 215 643 | reg no: C50263

project: Falls Creek Primary School Redesign
project address: 15 Slalom St, Falls Creek VIC 3699

client: Victorian Schools Building Authority (VSBA)

drawing: SITE PLAN & IMPLEMENTATION PLAN

drawing number: A100 revision: T1 drawn: AF checked: PM

scale: 1 : 200 @A1 date: 03.08.2022

stage: TENDER - NFC north

Notes:

- All existing conditions, dimensions and levels to be checked on site prior to commencing construction.
- All existing levels are indicative only. Survey drawing to take precedence over architectural drawings.
- Builder to refer any inconsistencies to the Architect for clarification.
- Builder to check that this drawing is the most recent amendment.
- Do not scale the drawings.