

15mm RUBBER WEAR LAYER AS DETAILED. RUBBER SURFACE WILL BE INSTALLED FLUSH WITH CONCRETE EDGE (NOT SHOWN IN THIS DETAIL)

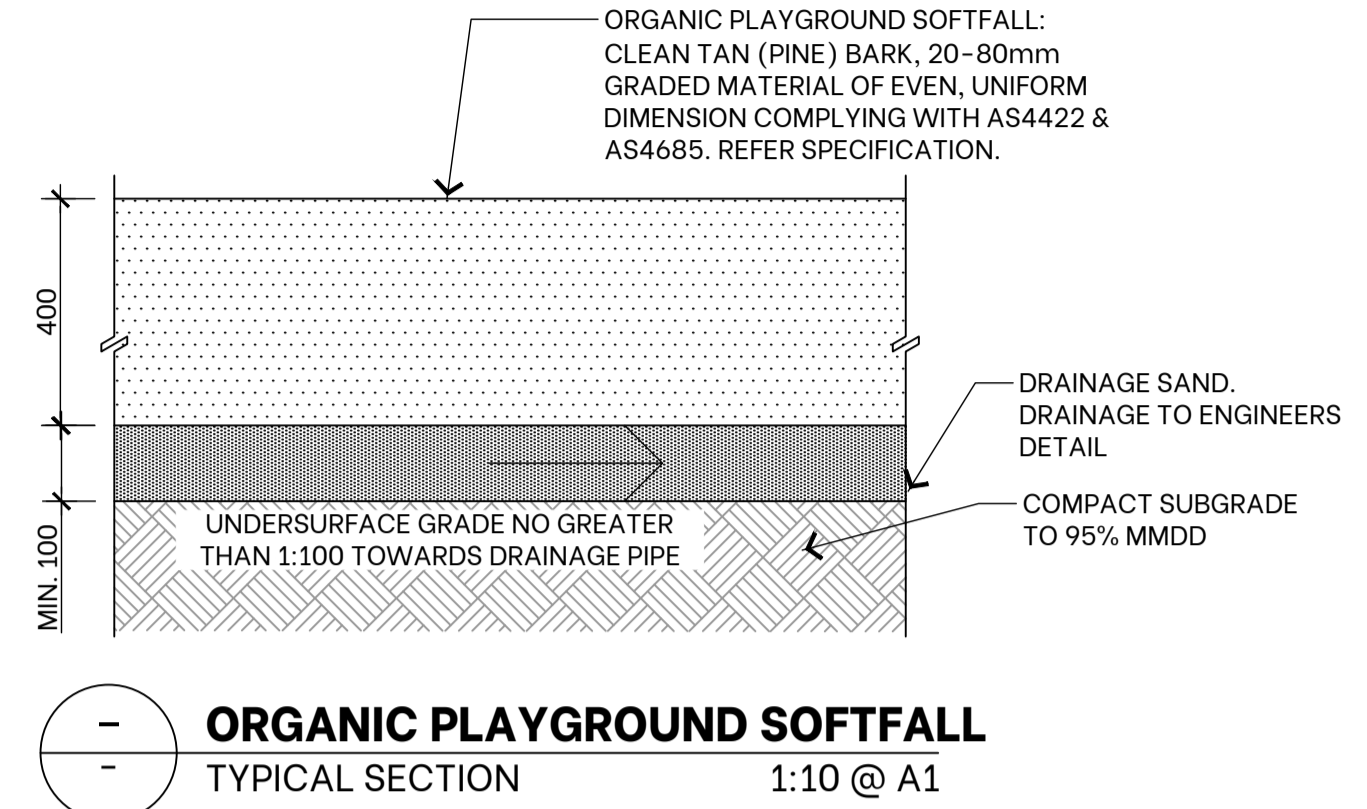

ALL IMPACT ATTENUATION LAYERS ARE TO COMPLY WITH AS4422 AND TO HAVE CRITICAL FALL HEIGHT (CFH) EQUIVALENT TO, OR EXCEEDING THE FREE HEIGHT OF FALL REQUIREMENTS OF EACH RESPECTIVE EQUIPMENT ITEM.

RUBBER WEAR LAYER SHALL CONSIST OF AUSTRALIAN MADE EPDM. CERTIFICATE OF AUTHENTICITY REQUIRED.

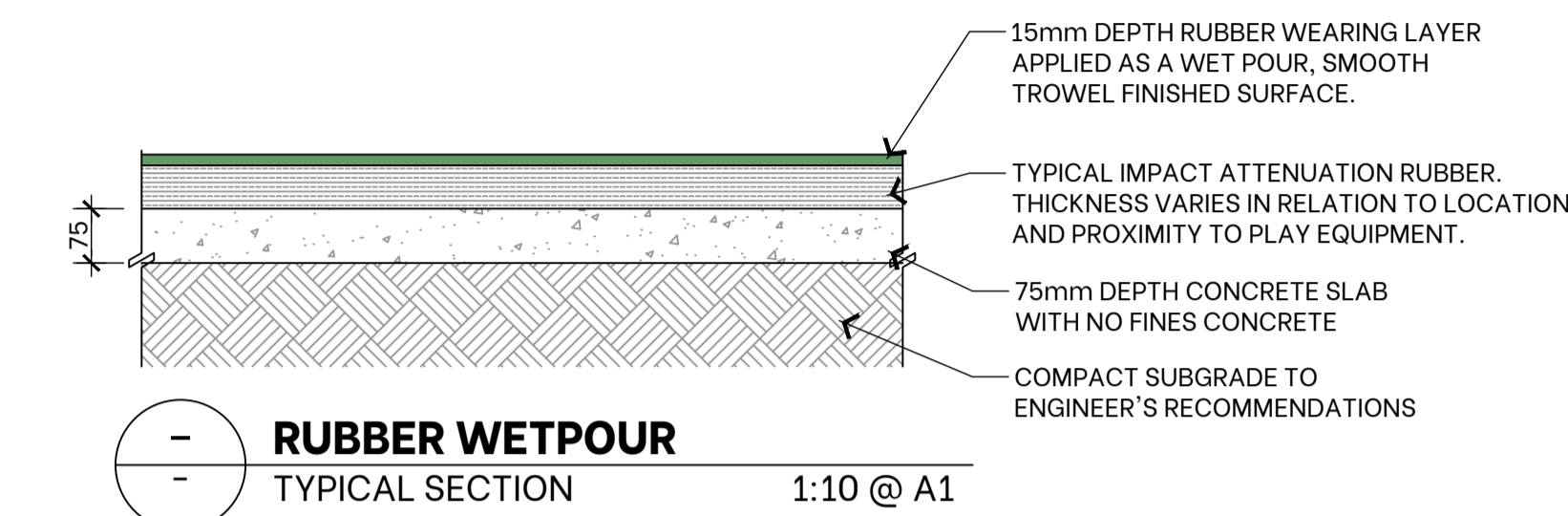
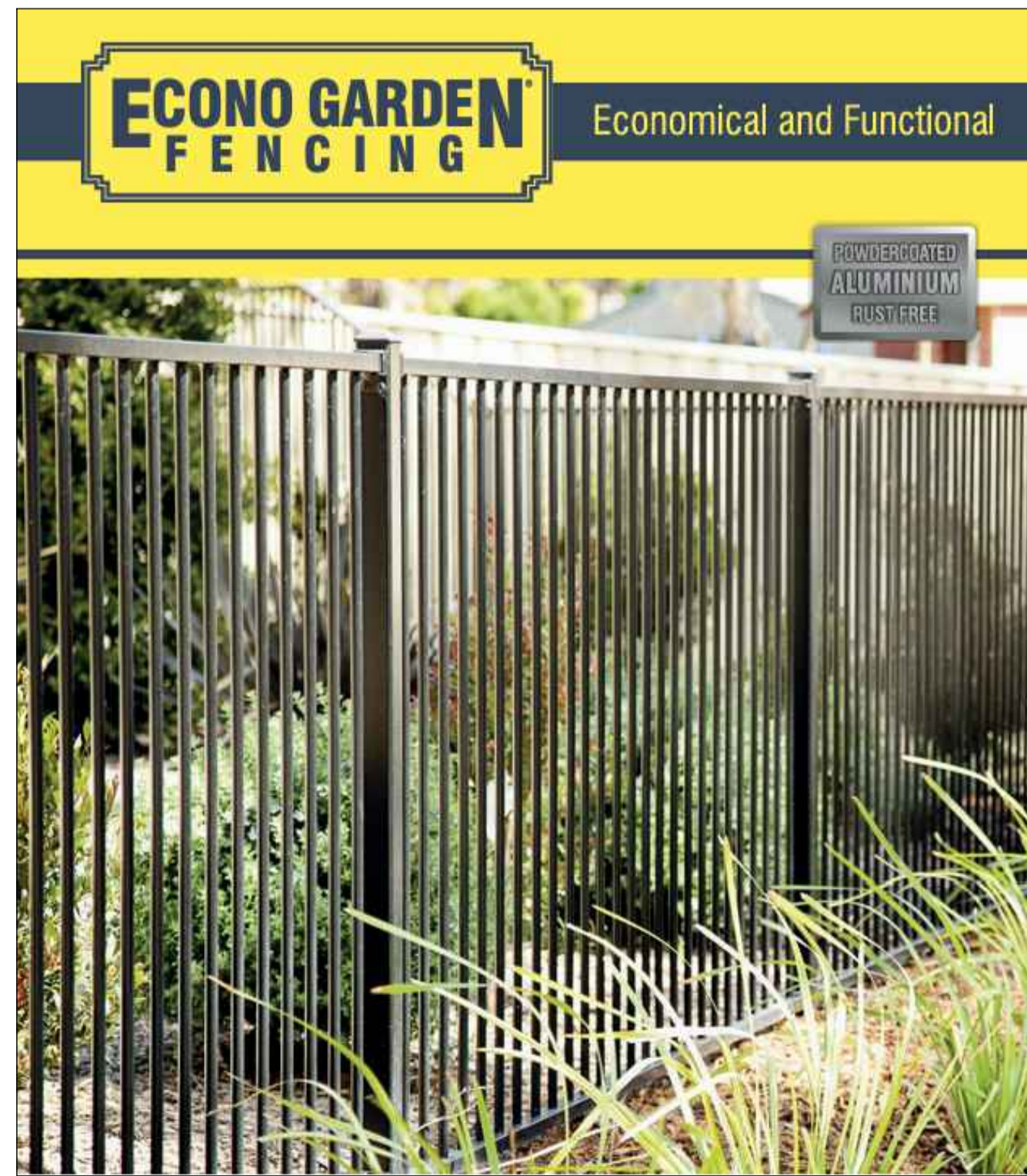
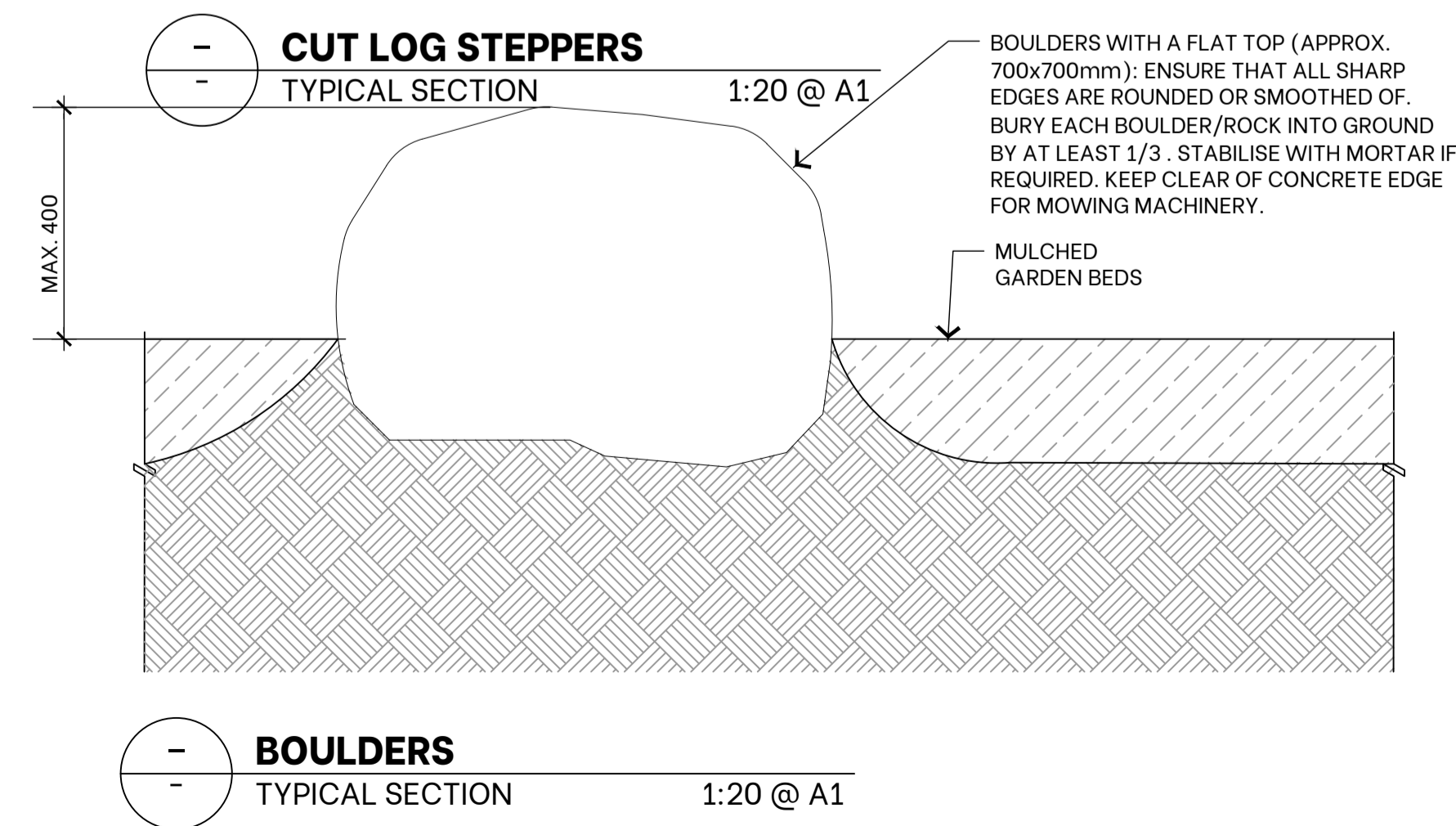
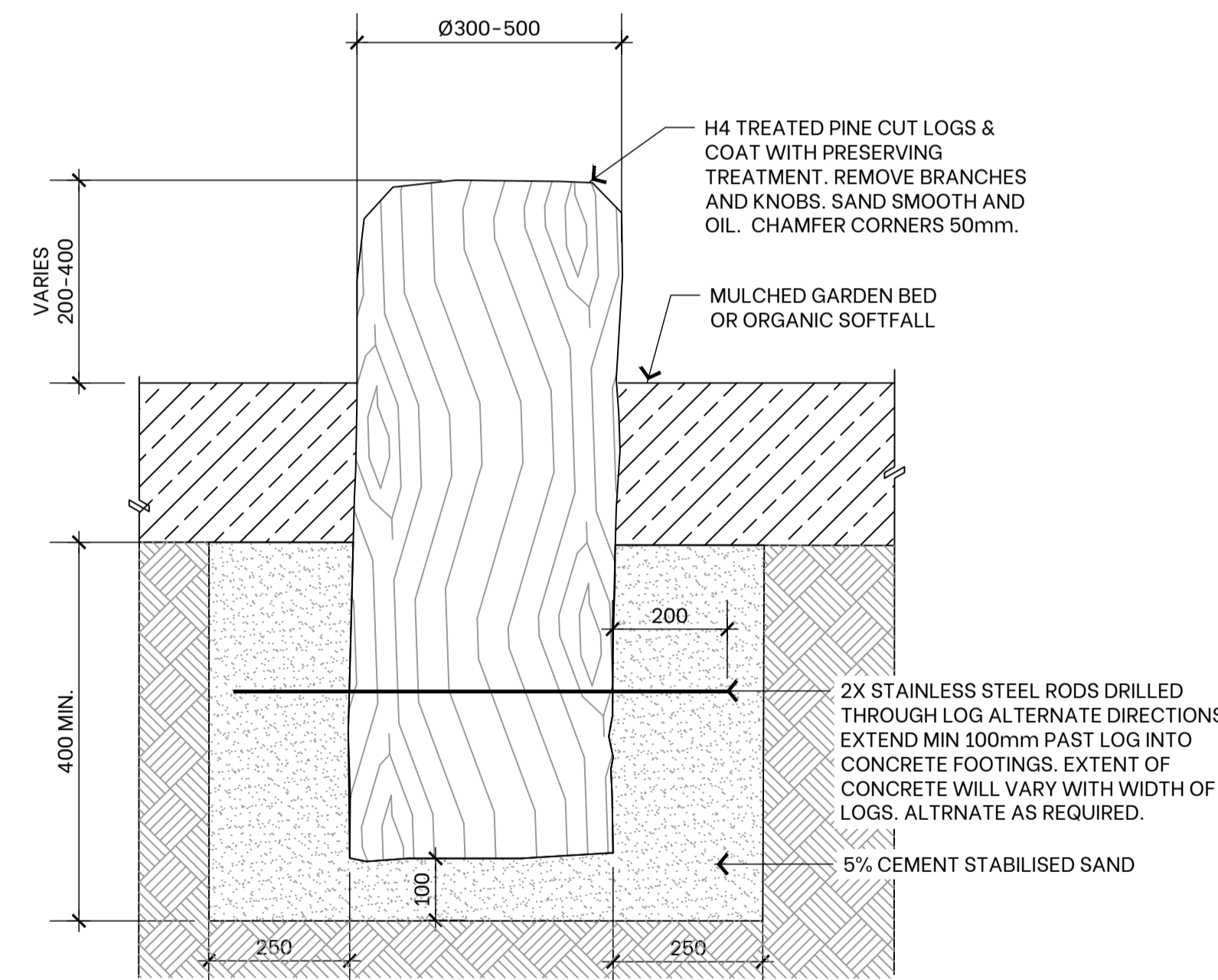
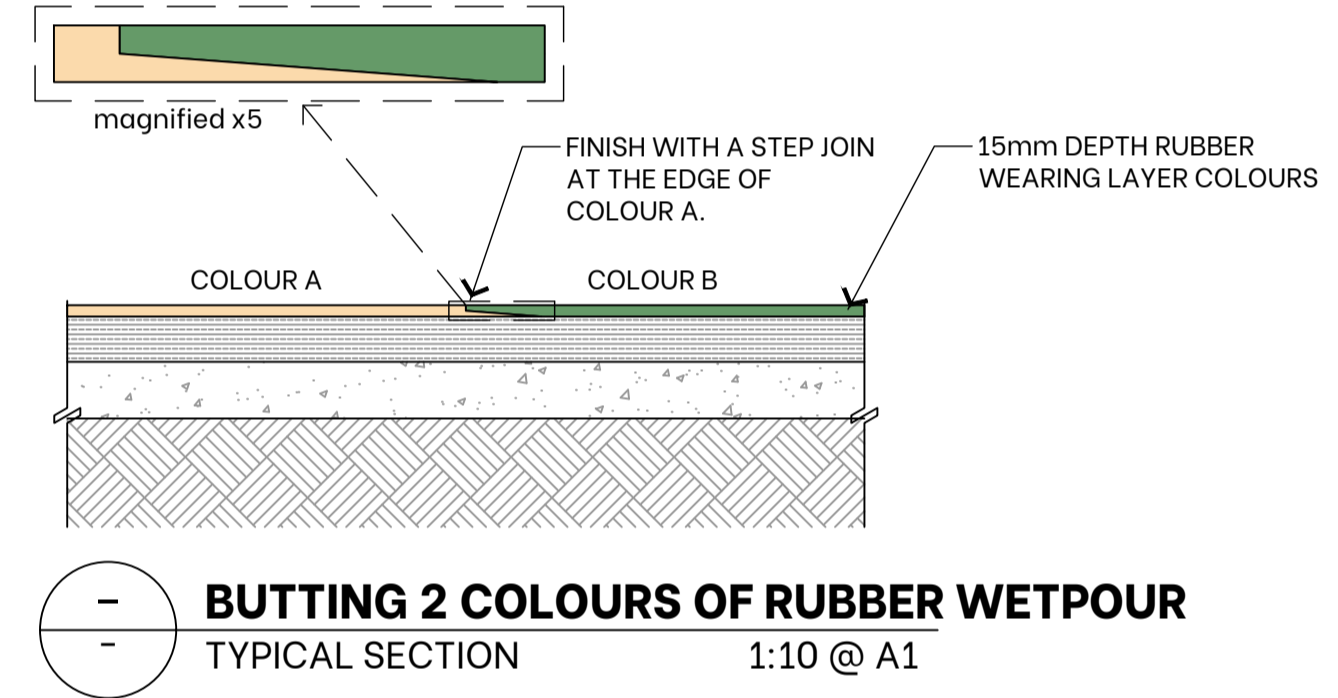
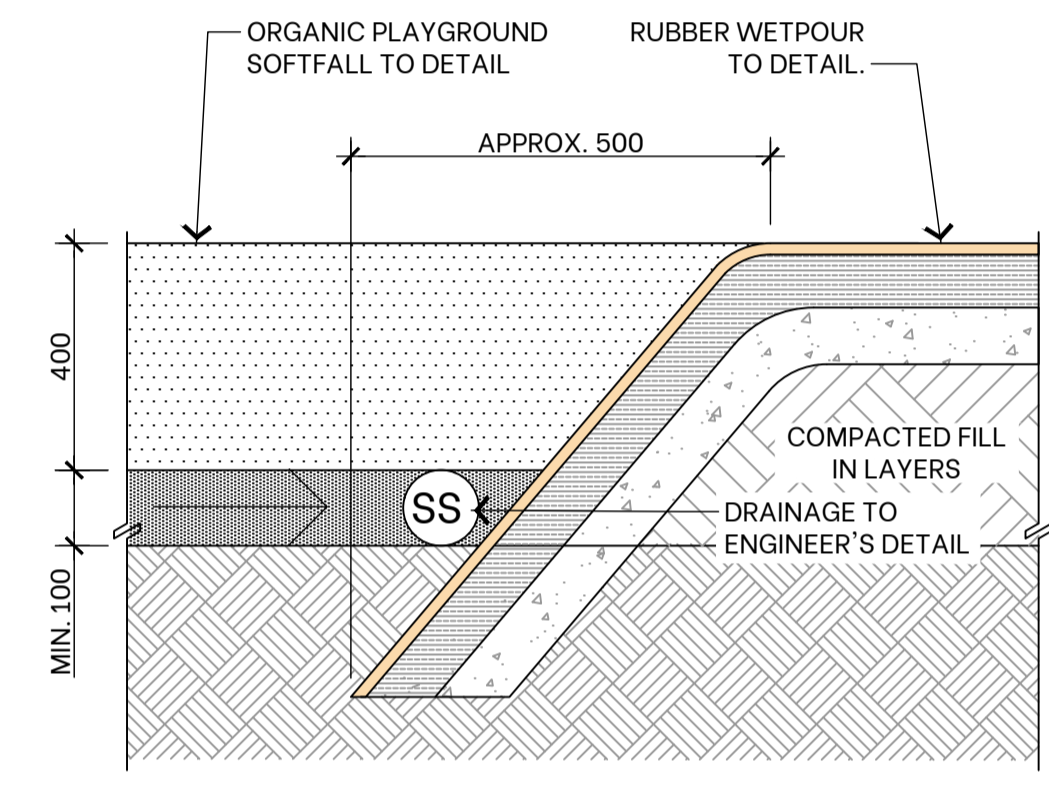

Econo Garden® Fence Panel	
Height	Width
900mm	2300mm
1100mm	2300mm

Econo Garden® Access Gate	
Height	Width
900mm	890mm
1100mm	890mm

Econo Garden® XL Access Gate	
Height	Width
900mm	1460mm
1100mm	1460mm

Econo Garden® Driveway Gate	
Height	Width
900mm	2 x 1460mm
1100mm	2 x 1460mm

Econo Posts	
Height	Size
1500mm	50x50mm
1800mm	50x50mm
2100mm	50x50mm

Deco Fence® Brackets	
Quantity	
4 Pack	

Specifications  
Econo Garden® range is an economic product made from long lasting powder coated aluminium. Finished in satin black only. This product is available in bulk ready to pick up today.  
Econo Garden® panels are NOT suitable for pool applications. Available in 900mm (H) & 1100mm (H)

Your Local Distributor

**PLAYGROUND FENCING**  
IMAGE

**PLAYGROUND FENCING**  
DETAILS

**BOULDERS**  
TYPICAL SECTION 1:20 @ A1

Revision	Revision Date	Revision Description	Issued By
A	25/11/2025	DRAFT TENDER ISSUE FOR REVIEW	TMW
B	01/05/2026	ISSUE FOR TENDER	TMW
C	18/05/2026	RE-ISSUE FOR TENDER	FIS

**yonder.**

PO Box 1198 Albury NSW 2640  
M 0423 911308  
E fiona@yonderstudio.com.au  
www.yonderstudio.com.au  
ABN 68 437 343 209

Client: WOODWARD LAND AND CIVIL  
Project: WODONGA CREEK ACTIVATION PROJECT LANDSCAPE WORKS

**LANDSCAPE DETAILS**

Drawing No: L-23050-LD01 C

Designed By: TMW  
Drawn By: TMW  
Reviewed By: FS

Scale:

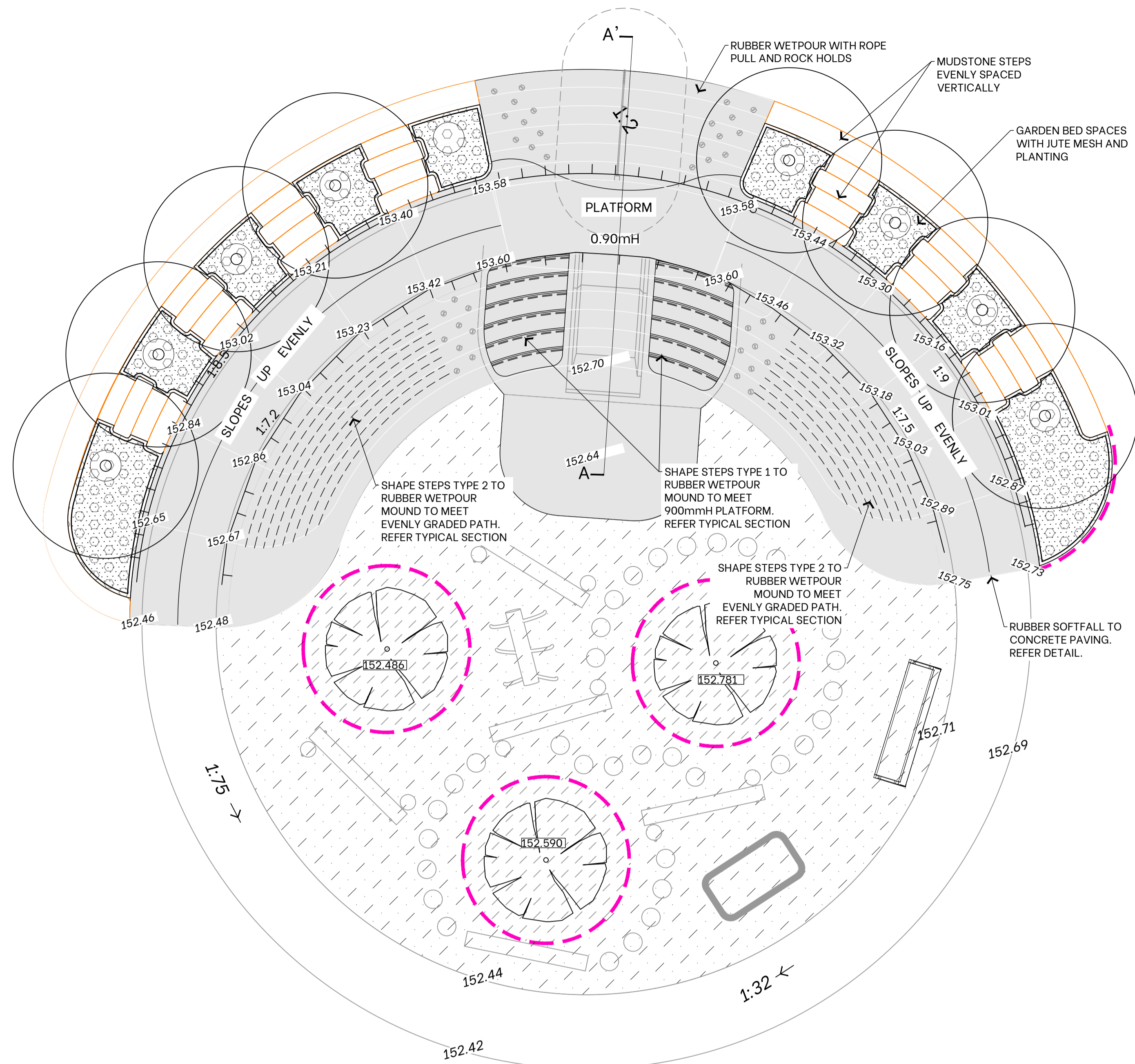

PLAYGROUND MOUND  
DETAIL PLAN  
1:50 @ A1

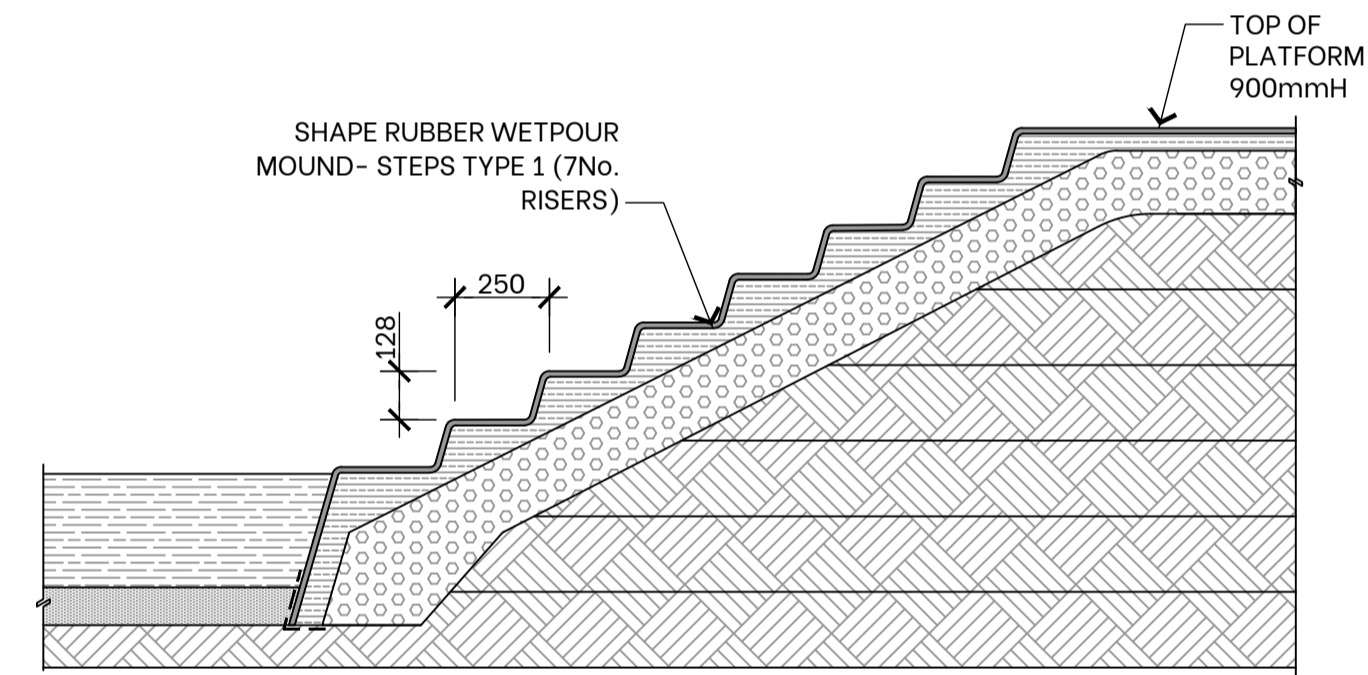

STEPS TYPE 1 ON PLAYGROUND MOUND  
TYPICAL SECTION  
1:20 @ A1

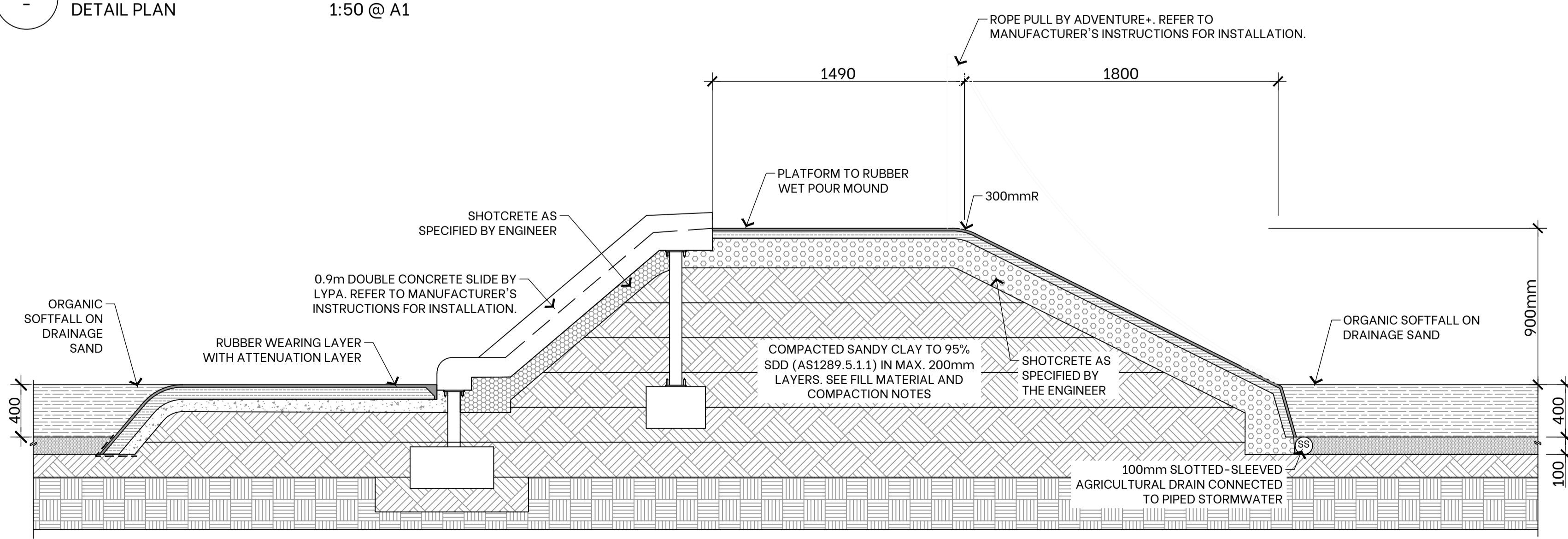

PLAYGROUND MOUND  
DETAIL SECTION  
1:20 @ A1

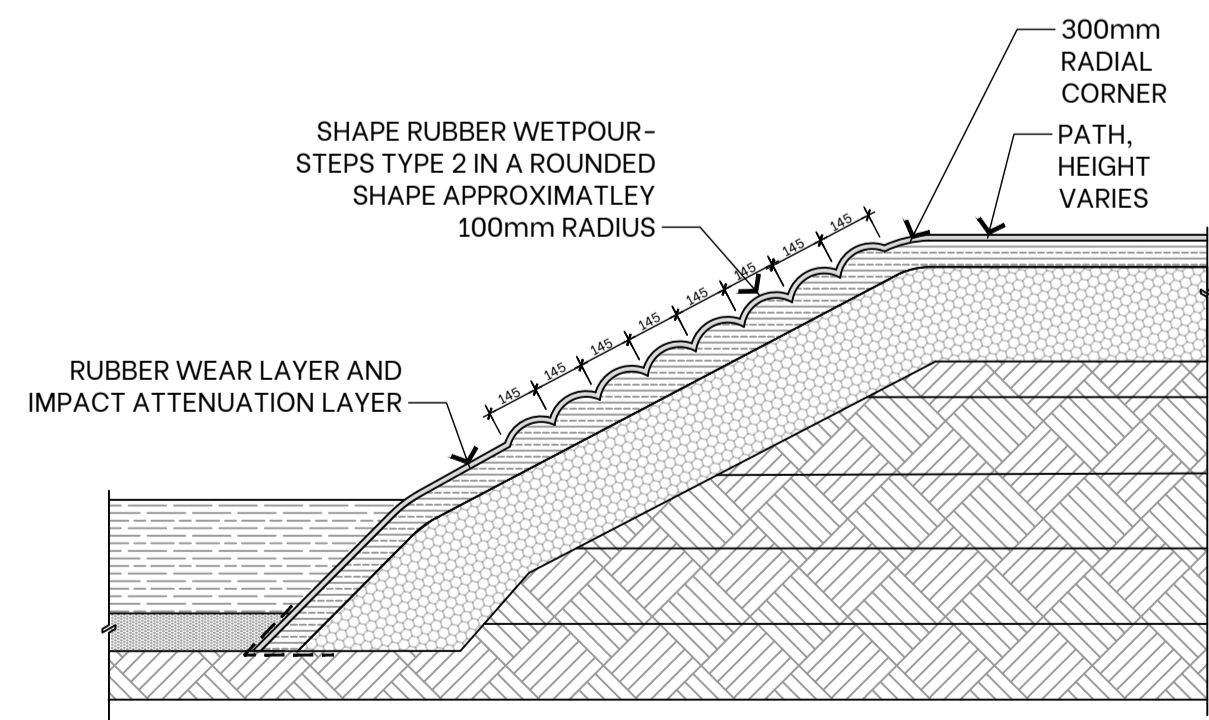

STEPS TYPE 2 ON PLAYGROUND MOUND  
TYPICAL SECTION  
1:20 @ A1

Revision	Revision Date	Revision Description	Issued By
A	25/11/2025	DRAFT TENDER ISSUE FOR REVIEW	TMW
B	01/05/2026	ISSUE FOR TENDER	TMW
C	18/05/2026	RE-ISSUE FOR TENDER	FIS

**yonder.**

PO Box 1198 Albury NSW 2640  
M 0423 811308  
E fiona@yonderstudio.com.au  
www.yonderstudio.com.au  
ABN 68 437 343 209

Client: WOODWARD LAND AND CIVIL  
Project: WODONGA CREEK ACTIVATION PROJECT  
LANDSCAPE WORKS

Sheet Title: **PLAYGROUND MOUND DETAILS**

Drawing No: **L-23050-LD02** **C**

Designed By: TMW  
Drawn By: TMW  
Reviewed By: FS  
Scale:

- NOTE**
- EXISTING PASTURE GRASS AND/OR WEEDS ARE TO BE SPRAYED WITH APPROVED GLYPHOSATE HERBICIDE.
  - GRASSED BATTERS SHALL BE A MAXIMUM GRADE OF 1:6.
  - CULTIVATE SUBGRADE TO 150mm DEPTH EXCEPT WITHIN THE DRIP LINE OF EXISTING TREES.
  - SUPPLY AND SPREAD MINIMUM DEPTH OF 100mm DEPTH APPROVED SITE / IMPORTED TOPSOIL (SANDY-LOAM) EXCEPT WITHIN DRIP LINE OF EXISTING TREES - TOPDRESS THESE AREAS WITH 50mm ONLY.
  - TOPSOIL TO BE RAKED TO A FINE TILTH. REMOVE ALL SURFACE ROCKS, LARGE LUMPS OF CLAY, WEEDS AND RUBBISH PRIOR TO SOWING.
  - SOW APPROVED GRASS SEED INTO TOPSOIL.
  - GRASS SEED MIX:
    - HARD FESCUE - 35% 100KG/HA
    - CREEPING RED FESCUE - 15% 45KG/HA
    - WHITE CLOVER - 5% 15KG/HA
    - KIKUYU - 30% 90KG/HA
    - FINE LEAF PERENNIAL RYEGRASS - 15% 40KG/HA
  - NEW GRASSED AREAS TO BE PROTECTED FROM TRESPASS AND TRAFFIC WITH STAR PICKETS AND BARRIER ROPE UNTIL GRASS IS ESTABLISHED.

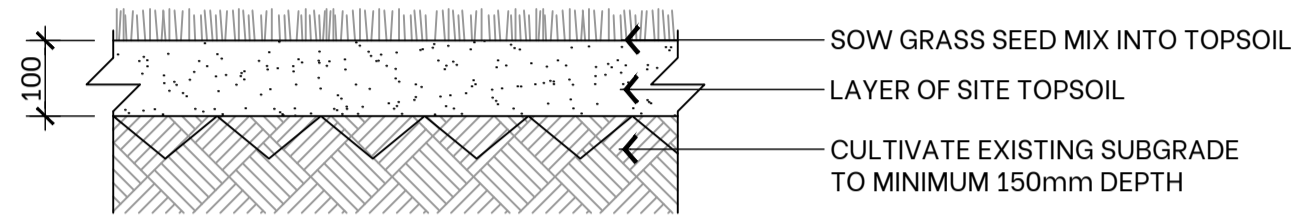

**GRASSING (non-irrigated)**  
TYPICAL SECTION 1:10 @ A1

- NOTE:**
- EXISTING PASTURE GRASS AND/OR WEEDS ARE TO BE SPRAYED WITH HERBICIDE.
  - SUBGRADE OF TURF AREAS TO BE CULTIVATED TO 150mm DEPTH.
  - TOPSOIL TO BE RAKED TO A FINE TILTH, REMOVAL OF ALL SURFACE ROCKS, LARGE LUMPS OF CLAY, WEEDS, RUBBISH PRIOR TO TURFING.
  - IF REQUIRED, NEWLY TURFED AREAS TO BE PROTECTED FROM TRESPASS AND TRAFFIC WITH STAR PICKETS AND BARRIER ROPE UNTIL GRASS IS ESTABLISHED.

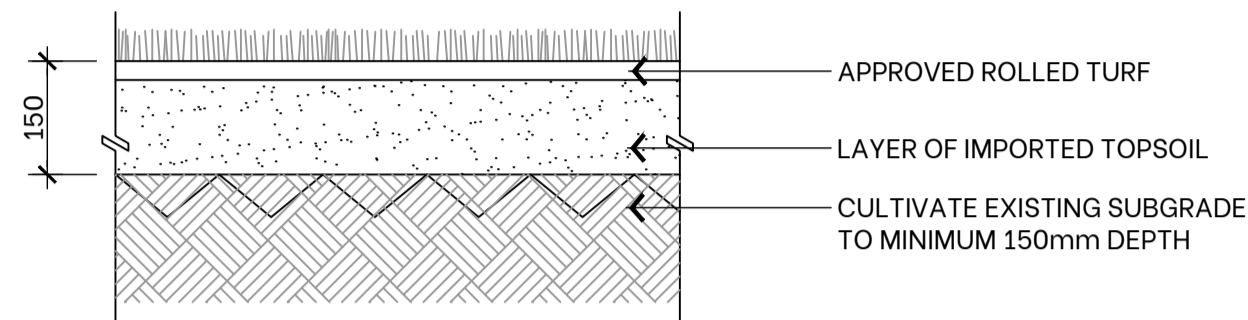

**ROLLED TURF (irrigated)**  
TYPICAL SECTION 1:10 @ A1

- NOTE:**
- GARDEN BEDS TO BE CROWNED TOWARDS CENTRE OF GARDEN BED WITH A MINIMUM 1:50 SLOPE

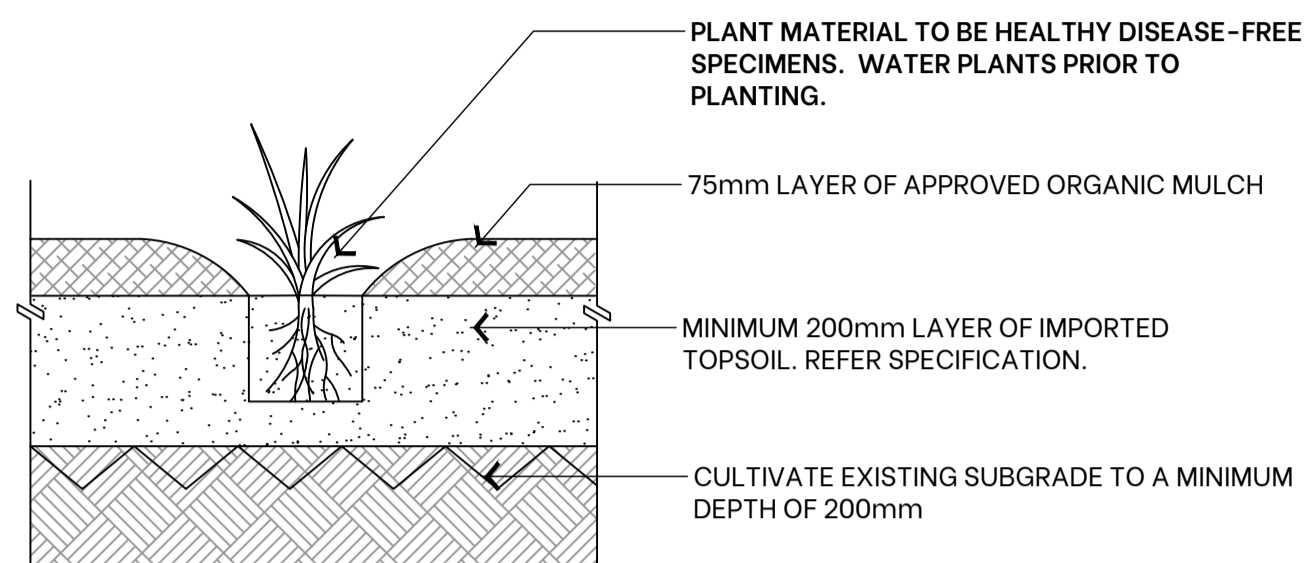

**PLANTING IN CULTIVATED MULCHED GARDEN BEDS**  
TYPICAL SECTION 1:10 @ A1

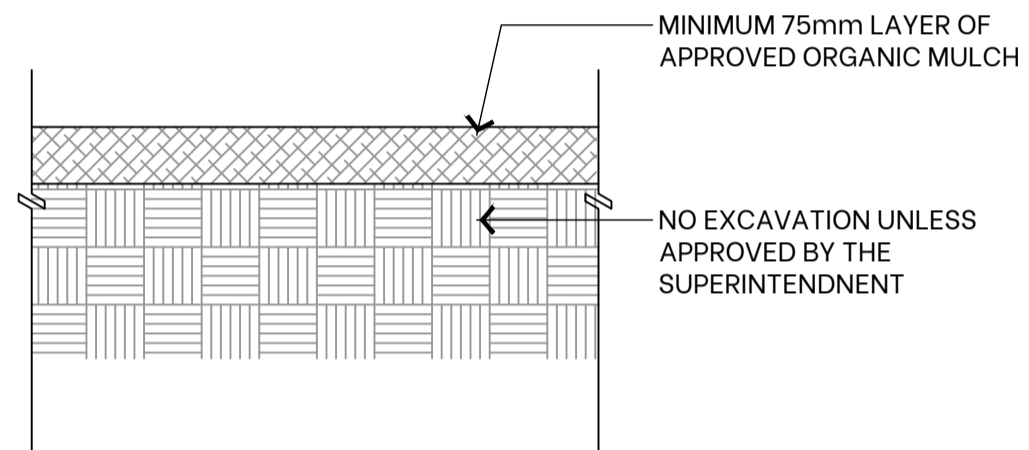

**MULCH ONLY - NO CULTIVATION**  
TYPICAL SECTION 1:10 @ A1

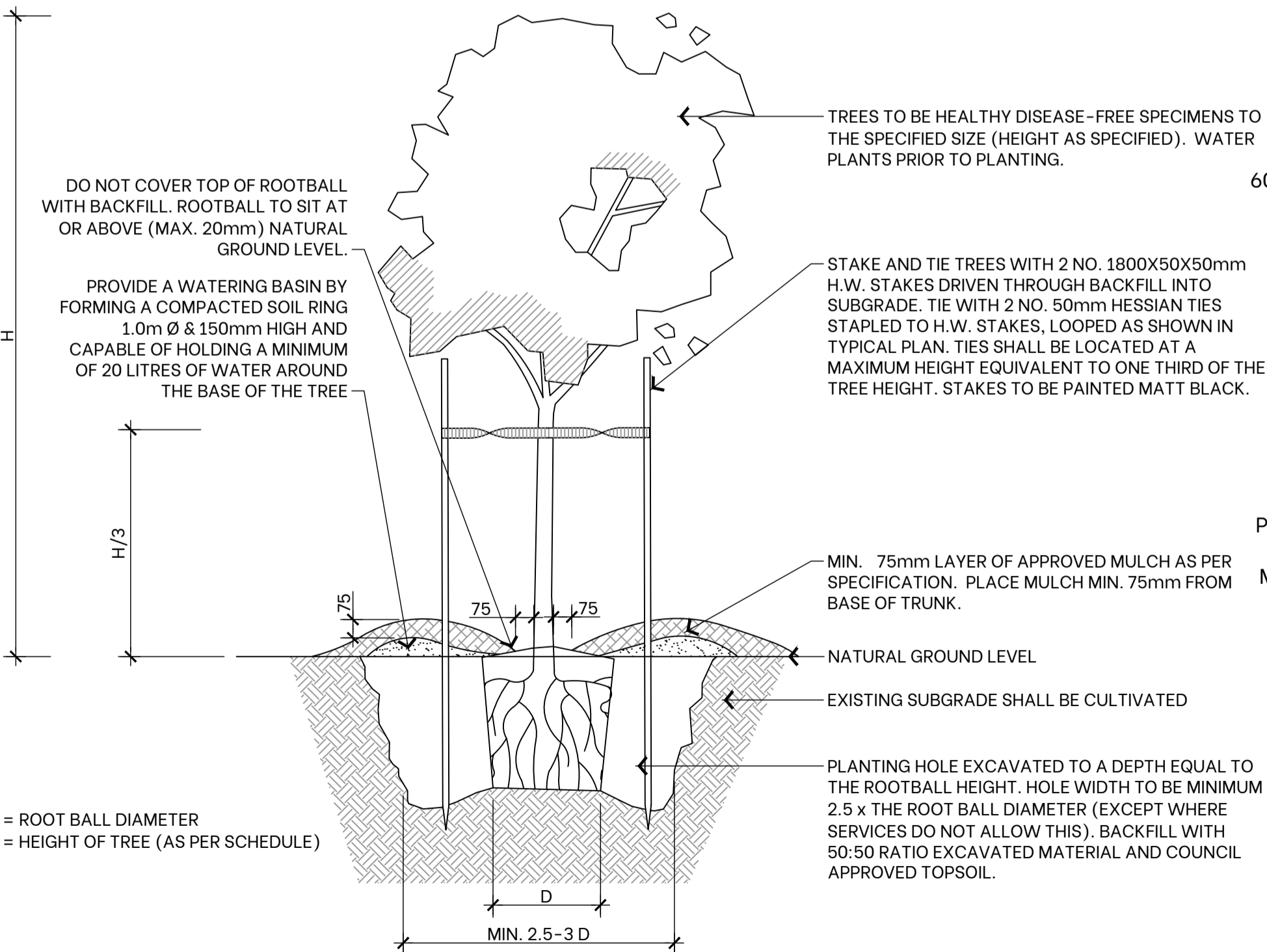
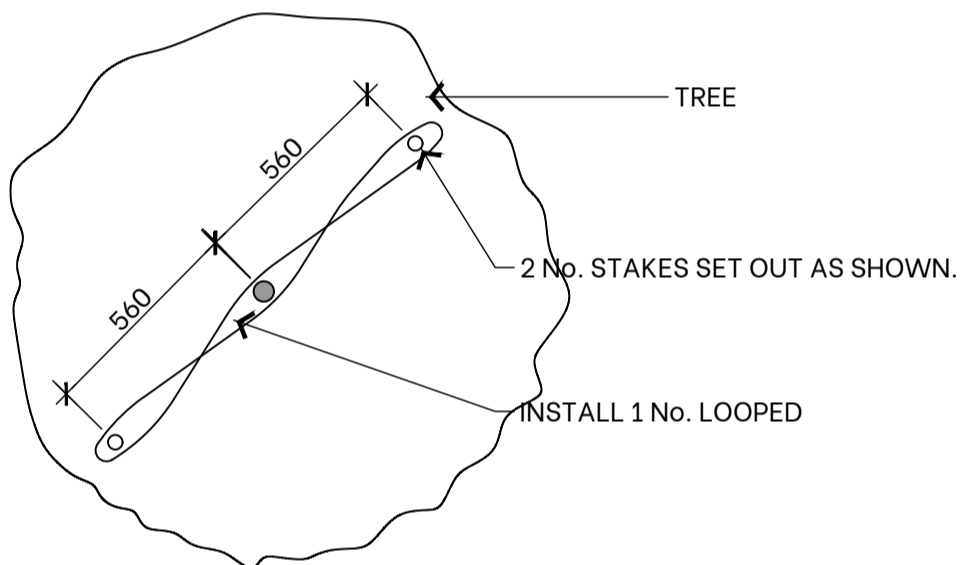

**TREE PLANTING IN GRASS/GARDEN BEDS**  
TYPICAL SECTION AND PLAN 1:20 @ A1

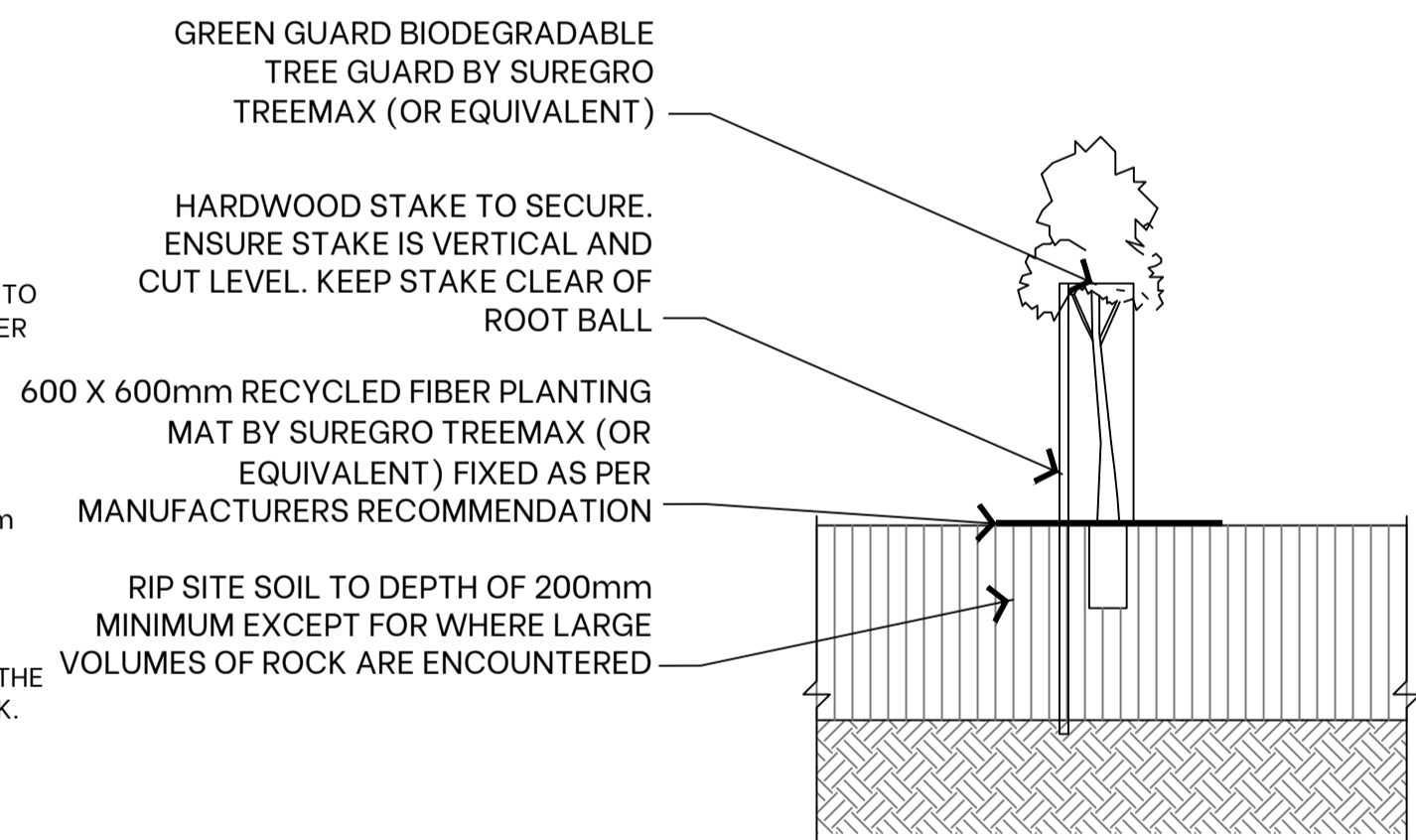

**TUBESTOCK PLANTING**  
TYPICAL SECTION 1:10 @ A1

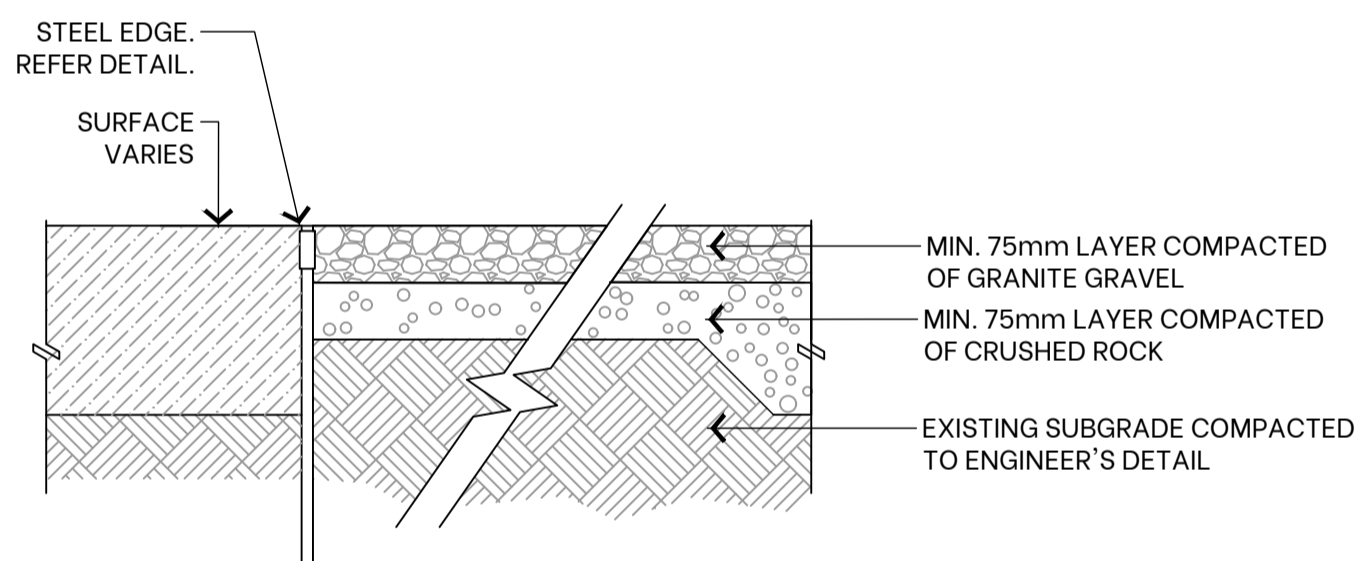

**STEEL EDGE TO COMPACTED GRAVEL**  
TYPICAL SECTION 1:10 @ A1

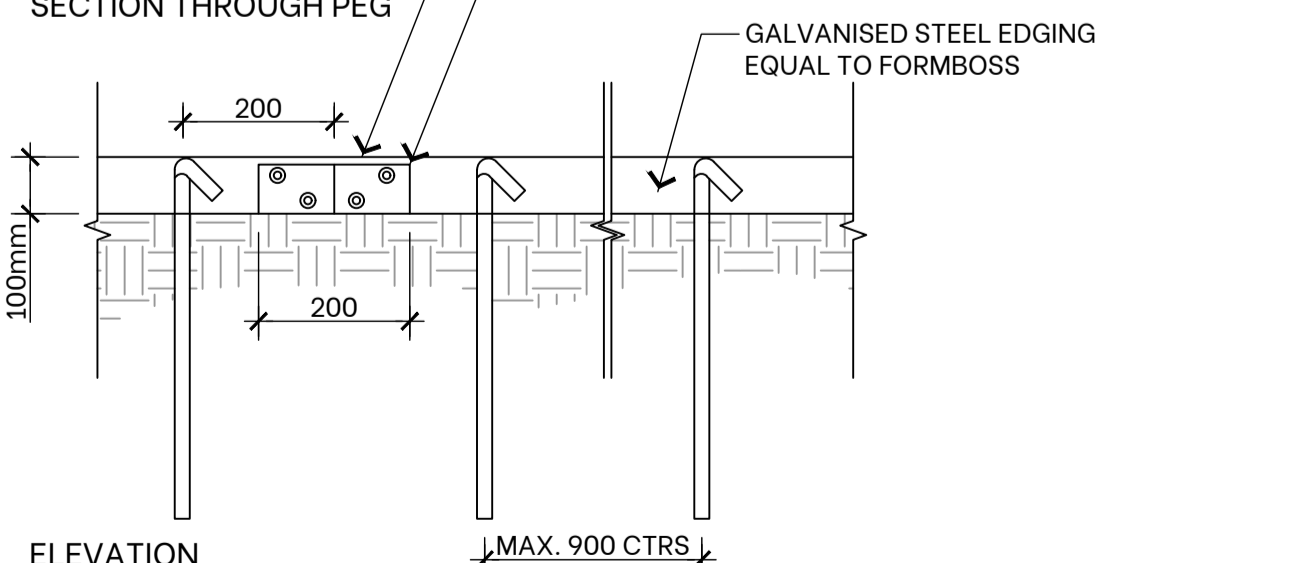
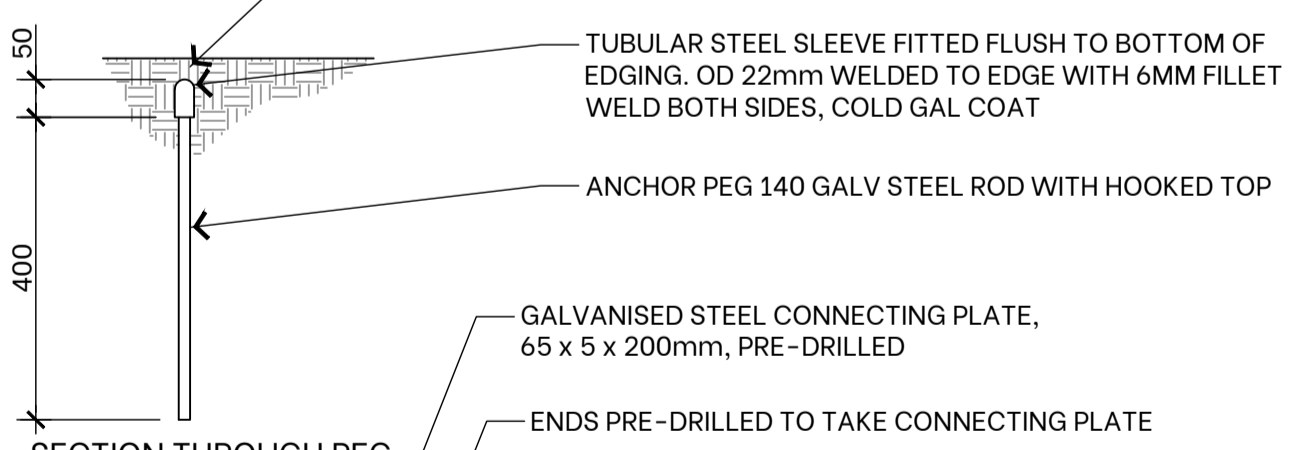

**STEEL EDGE**  
ELEVATION 1:10 @ A1

Revision	Revision Date	Revision Description	Issued By
A	25/11/2025	DRAFT TENDER ISSUE FOR REVIEW	TMW
B	01/05/2026	ISSUE FOR TENDER	TMW
C	18/05/2026	RE-ISSUE FOR TENDER	FIS

**yonder.**

PO Box 1198 Albury NSW 2640  
M 0423 811308  
E fiona@yonderstudio.com.au  
www.yonderstudio.com.au  
ABN 68 437 343 209

Client	WOODWARD LAND AND CIVIL
Project	WODONGA CREEK ACTIVATION PROJECT LANDSCAPE WORKS

**SHEET TITLE**  
**SOFT LANDSCAPE DETAILS**

Drawing No	L-23050-LD03	C
------------	--------------	---

Designed By	TMW
Drawn By	TMW
Reviewed By	FS
Scale	