

1. SEWER PUMP STATION NOTE

2. REMOVE EXISTING TOILET BLOCK AND REPLACE WITH BELOW SPECIFICATION OR APPROVED EQUIVALENT:

AQUATEC MODEL D/PSS/3404B0321 DUPLEX PRESSURE SEWER SYSTEM, INCORPORATING:
 2 X OGPZ 1.5KW, 415V, THREE PHASE SUBMERSIBLE TWO STAGE CENTRIFUGAL PRESSURE SEWER GRINDER PUMP, FITTED WITH STAINLESS STEEL BASES AND 15M CABLES. PUMPS WILL BE PLUMBED IN PN16 FLEXIBLE PIPEWORK TO ALL REQUIRED 316 SS NON RETURN VALVES AND ISOLATION VALVES. PUMPS AND PIPEWORK WILL BE MOUNTED INSIDE AN 1500 LITRE (1000MM DIAMETER X 2200MM DEEP WITH 1700MM MAX INVERT) POLYETHYLENE CHAMBER MANUFACTURED TO AS/NZS WITH A LIGHT DUTY CLASS B CAST IRON COVER.
 OMNISMART MULTI, SMART DUAL PUMP CONTROL PANEL WITH ALL REQUIRED STARTING, OPERATION, PROTECTION AND ABILITY TO BE UPGRADED TO FULL REMOTE COMMUNICATION IF REQUIRED IN FUTURE.
 PANEL INCLUDES AN AUDIBLE AND VISUAL ALARM WHICH WILL BE ACTIVATED VIA A FACTORY PRESET 4-20MA HYDROSTATIC TRANSDUCER AND HAS A USB PORT FOR UPLOADING PROGRAMS OR DOWNLOADING LOGGED DATA, A BACKLIT LCD SCREEN FOR SYSTEM STATUS & OPERATION INFORMATION.
 ALL CONTROL EQUIPMENT WILL BE MOUNTED INSIDE A REMOTE MOUNTED, LOCKABLE, WEATHER PROOF GR 316 S/S ENCLOSURE.
 CONTRACTOR TO RECONNECT ALL POWER AS REQUIRED FOR CLEAN WORKING ORDER PUMP STATION HANDOVER TO COUNCIL.

LEGEND

- ExW --- Existing Water Main
- ExR --- Existing Recycled Water Main
- ExW --- Existing Water Main Decommissioned
- ExE --- Existing Underground Electricity
- ExEOH --- Existing Overhead Elec & Pole
- ExT --- Existing Telstra & Service Pit
- ExCOM --- Existing Comm. / Optic Fibre
- ExG --- Existing Gas Main
- ExS --- Existing Fence
- ExS --- Existing Sewer & Manhole
- Ex4500 --- Existing Stormwater Drain & Pit
- Proposed Kerb
- W --- Proposed Water
- Proposed Subsoil Drainage
- EUG --- Proposed Electricity Underground Conduited
- S --- Proposed Sewer Gravity
- S --- Proposed Sewer Rising Main
- Proposed Irrigated Extent
- 4500 --- Proposed Stormwater Drain & Pit
- Existing Tree to be Retained (Surveyed Canopy)
- Existing Tree to be Removed
- New Pavement / Footpath
- Feature Concrete

Rev.	Description	Approved	Date
B	ISSUE FOR TENDER	JF	21/05/2026
A	PRELIMINARY	JF	1/05/2026

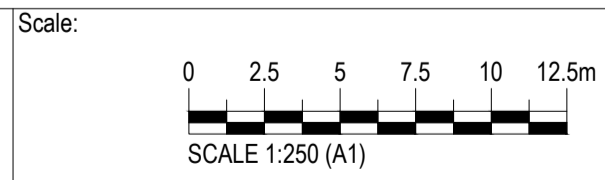

© Woodward Land & Civil Pty Ltd All Rights Reserved
 This document is produced by Woodward Land & Civil solely for the benefit of and use by the client in accordance with the terms of the retainer. Woodward Land & Civil Pty Ltd does not and shall not assume any responsibility or liability whatsoever to any third party arising out of any use or reliance by third party on the content of this documents.

Woodward

WOODWARD LAND & CIVIL PTY LTD
 ACN 637 572 466
 T: 0403 090 178
 info@woodwardcivil.com.au

North:

Drawing Status:
TENDER ISSUE
 (NOT FOR CONSTRUCTION)

PLANSET C - DIAMOND PARK WODONGA CREEK ACTIVATION PARK SERVICING- PLAN 1

Designed : J.F.	Date : JULY 2025
Authorised : S.H.W.	Checked : S.H.W.
Drawing No. : W023022-C-SER2	Revision : B

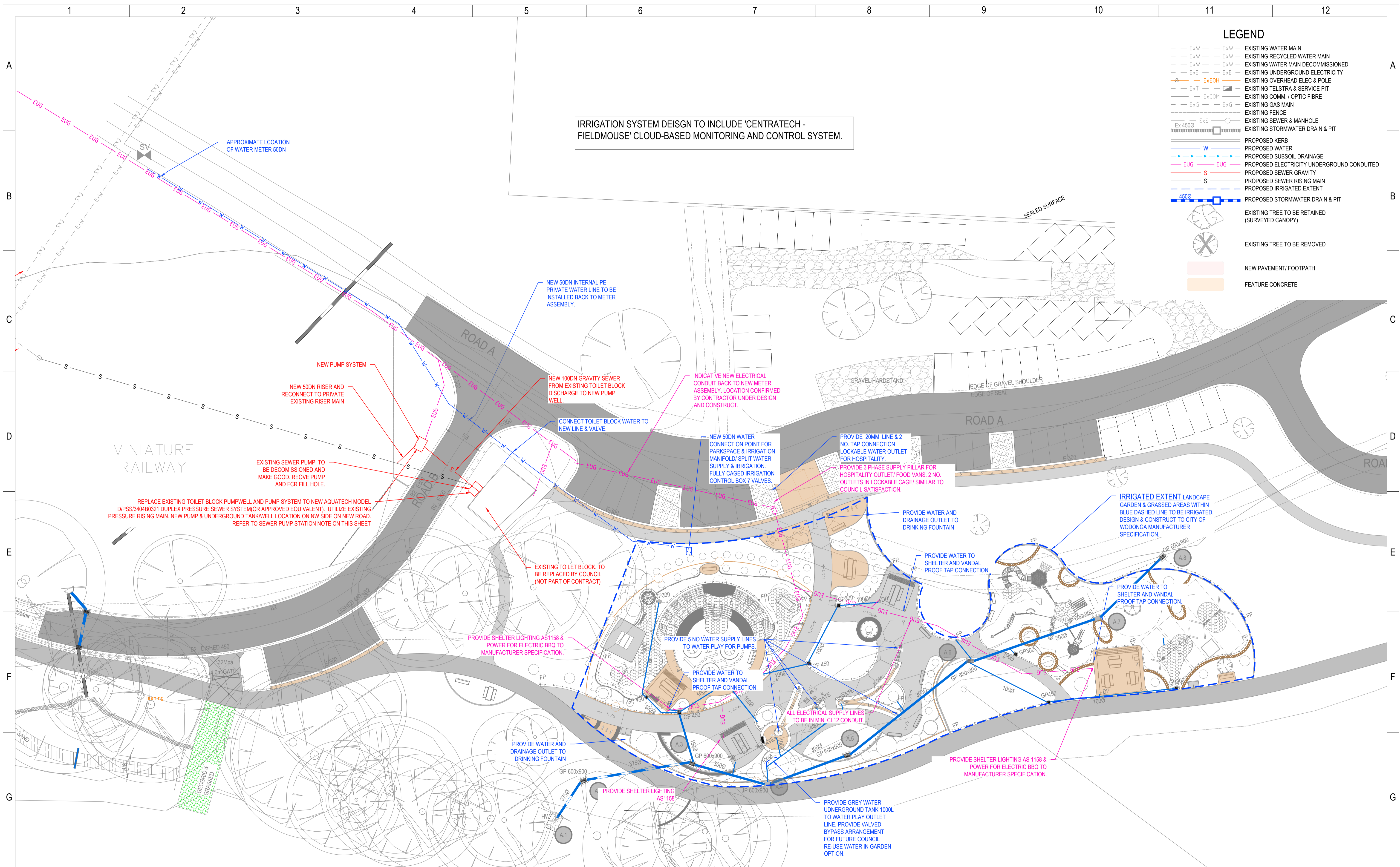

IRRIGATION SYSTEM DESIGN TO INCLUDE 'CENTRATECH - FIELDMOUSE' CLOUD-BASED MONITORING AND CONTROL SYSTEM.

- LEGEND**
- ExW --- Existing WATER MAIN
 - ExW --- Existing RECYCLED WATER MAIN
 - ExW --- Existing WATER MAIN DECOMMISSIONED
 - ExE --- Existing UNDERGROUND ELECTRICITY
 - ExT --- Existing OVERHEAD ELEC & POLE
 - ExT --- Existing TELSTRA & SERVICE PIT
 - ExCOM --- Existing COMM. / OPTIC FIBRE
 - ExG --- Existing GAS MAIN
 - Existing FENCE
 - ExS --- Existing SEWER & MANHOLE
 - Existing STORMWATER DRAIN & PIT
 - Proposed KERB
 - W --- Proposed WATER
 - EUG --- Proposed SUBSOIL DRAINAGE
 - EUG --- Proposed ELECTRICITY UNDERGROUND CONDUITED
 - S --- Proposed SEWER GRAVITY
 - S --- Proposed SEWER RISING MAIN
 - Proposed IRRIGATED EXTENT
 - 4500 --- Proposed STORMWATER DRAIN & PIT
 - Existing TREE TO BE RETAINED (SURVEYED CANOPY)
 - Existing TREE TO BE REMOVED
 - NEW PAVEMENT/ FOOTPATH
 - FEATURE CONCRETE

Rev.	Description	Approved	Date
B	ISSUE FOR TENDER	JF	21/05/2026
A	PRELIMINARY	JF	1/05/2026

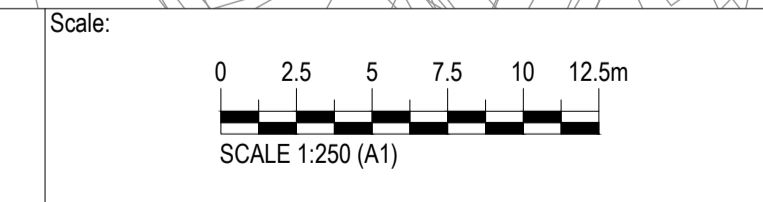

© Woodward Land & Civil Pty Ltd All Rights Reserved
 This document is produced by Woodward Land & Civil solely for the benefit of and use by the client in accordance with the terms of the retainer. Woodward Land & Civil Pty Ltd does not and shall not assume any responsibility or liability whatsoever to any third party arising out of any use or reliance by third party on the content of this documents.

Woodward
 WOODWARD LAND & CIVIL PTY LTD
 ACN 637 572 466
 T: 0403 090 178
 info@woodwardcivil.com.au

North:

Drawing Status:
TENDER ISSUE
 (NOT FOR CONSTRUCTION)

PLANSET C - DIAMOND PARK WODONGA CREEK ACTIVATION PARK SERVICING PLAN 2

Designed : J.F.	Date : JULY 2025
Authorised : S.H.W.	Checked : S.H.W.
Drawing No. : W023022-C-SER3	Revision : B